

# FERRITES

## SPLIT TOROIDAL CORES WITH PLASTIC CASE (RRC)

### FEATURES

As protection against unwanted EMI radiation in digital equipment such as personal computers, word processors, fax machines, display equipment, photocopiers, computer consoles etc; ensuring immunity against trasmission and other types of noise in such equipment, is essential.

Material: A5

Plastic Case Material: PA66 (NYLON) 94V-0



For performance and mechanical data on these parts please refer to the typical data.

*Dimensions in mm.*

Part number	Dimension					Impedance		Form
	A	B	C	D	E	25 Mhz	100 Mhz	
RRC10-05-20-M	12.00	5.00	25.50	13.00	2.40	93	158	3
RRC12-07-15-M	14.00	7.00	18.00	15.50	22.00	47	101	2
RRC16-08-13-M	19.50	8.50	17.00	23.00	23.00	60	120	1
RRC16-08-16-M	19.50	8.50	20.00	23.00	26.00	75	160	1
RRC20-10-10-M	24.50	10.00	13.50	28.50	20.00	50	105	1
RRC24-11-14-M	28.00	11.50	18.00	31.50	24.00	70	140	1
RRC25-15-12-M	29.00	14.00	15.50	33.00	21.50	45	100	1
RRC16-09-28-M1	19.50	10.00	31.50	20.50	35.50	120	190	2
RRC16-09-28-M2	18.50	9.50	36.00	20.50	6.50	120	190	3

*Other sizes are available upon request*

*Impedance figures are typical values.*

### ORDERING CODE

**RRC - 16 - 08 - 16 - M**

(1) (2) (3) (4) (5)

- (1) PART NO.
- (2) CORE OD.
- (3) CORE ID.
- (4) CORE LENGTH
- (5) PLASTIC CLAMPS

SHAPE



SHAPE 1

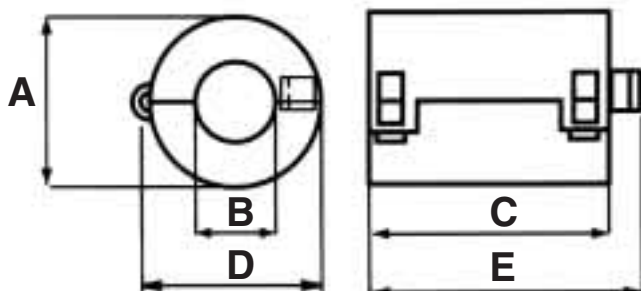
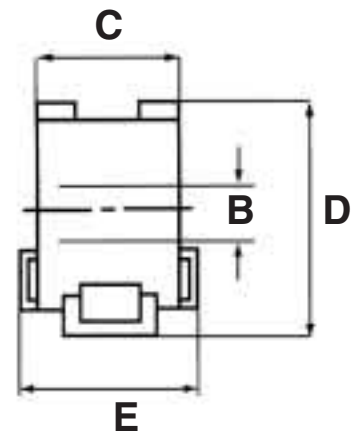

SHAPE 2

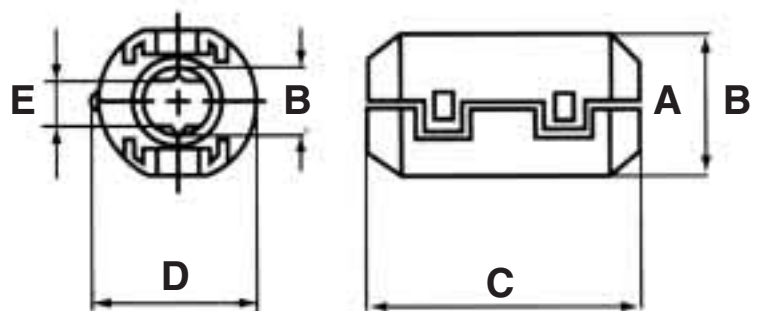

SHAPE 3

# FERRITES

## SPLIT TOROIDAL CORES WITH PLASTIC CASE (RRC)

### TYPICAL DATA

#### RRC 10-5-20-M

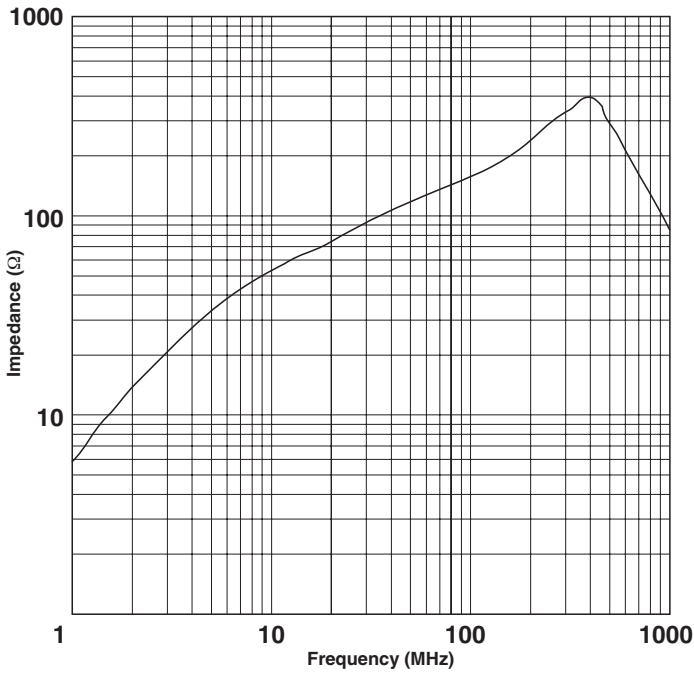

#### RRC 16-8-13-M

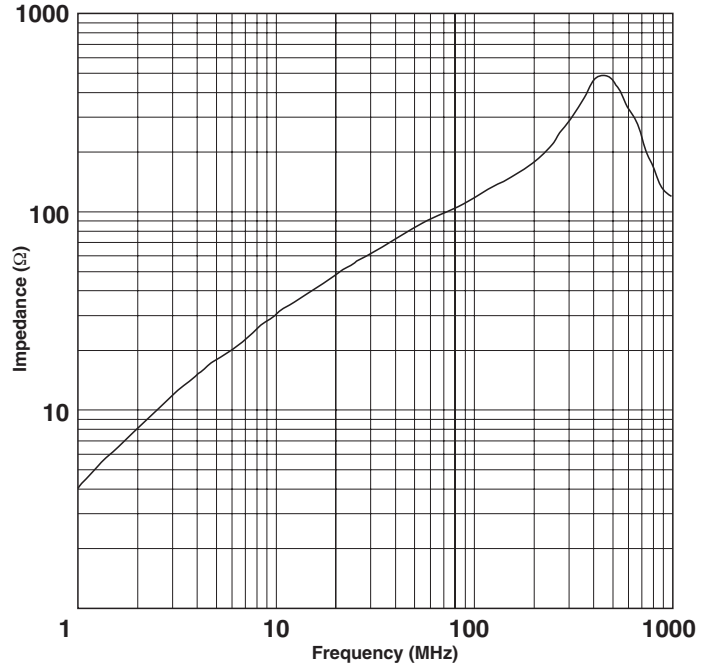

#### RRC 16-8-16-M

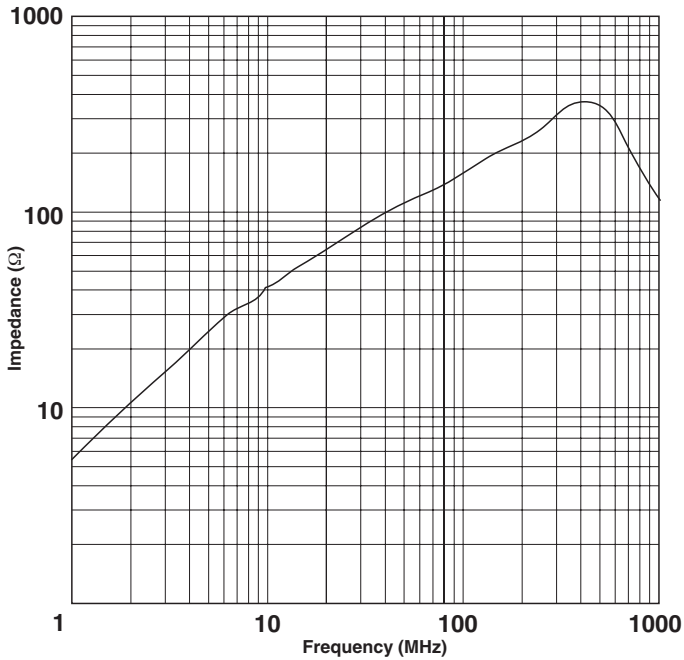

#### RRC 16- 9 -28 -M

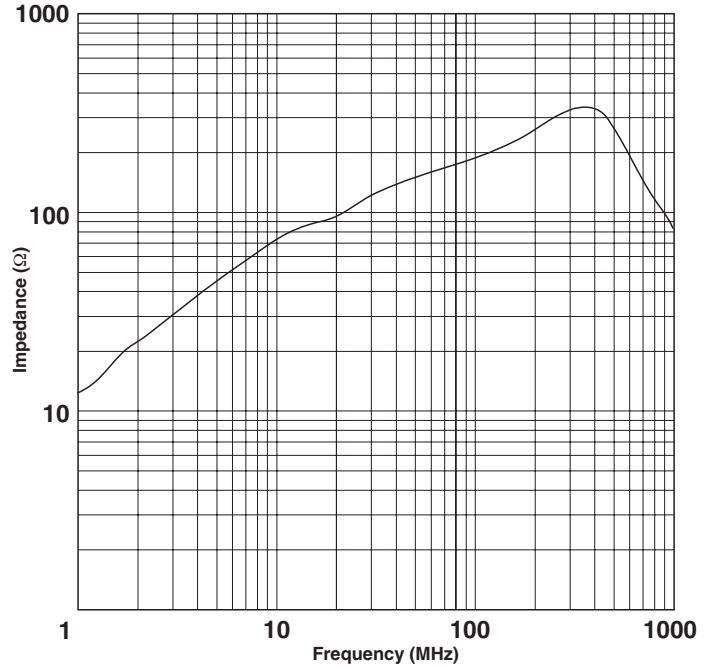

All dimensions shown are standard.  
However, other variations can be made  
upon individual customer request.

# FERRITES

## SPLIT TOROIDAL CORES WITH PLASTIC CASE (RRC)

### TYPICAL DATA

#### RRC 16-9-28-M2

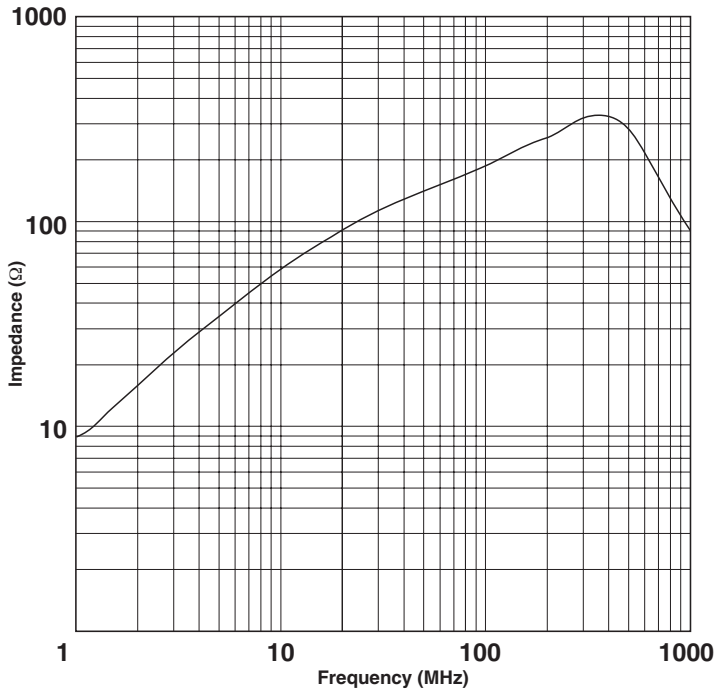

#### RRC 20-10-10-M

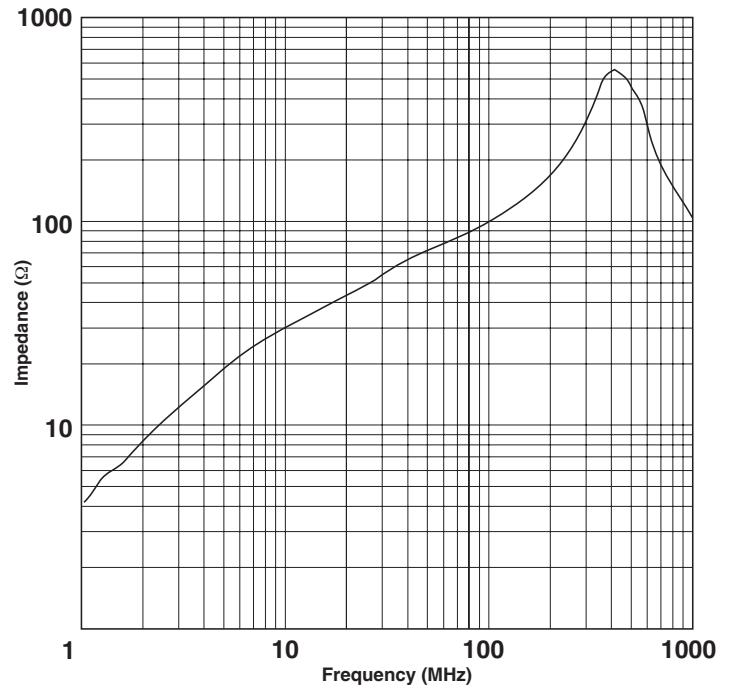

#### RRC 24-11-14-M

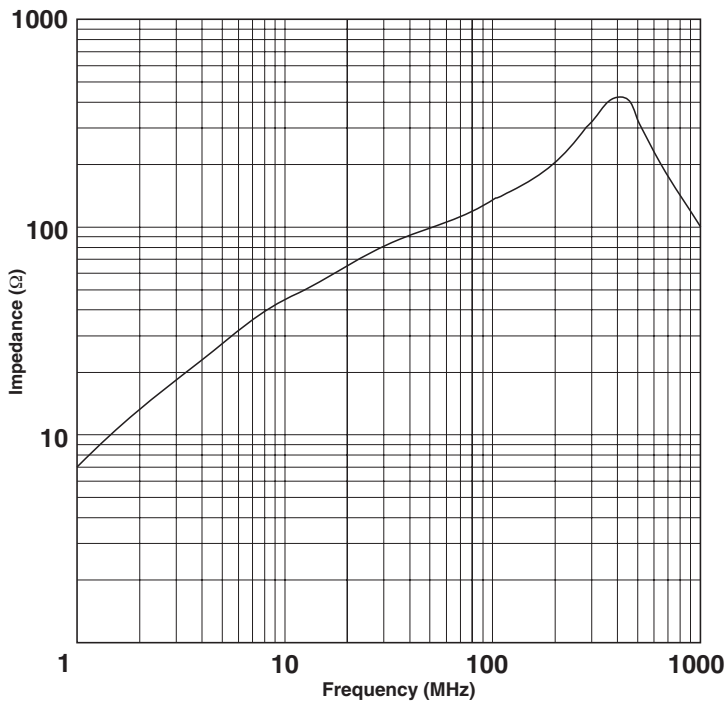

#### RRC 25-15-12-M

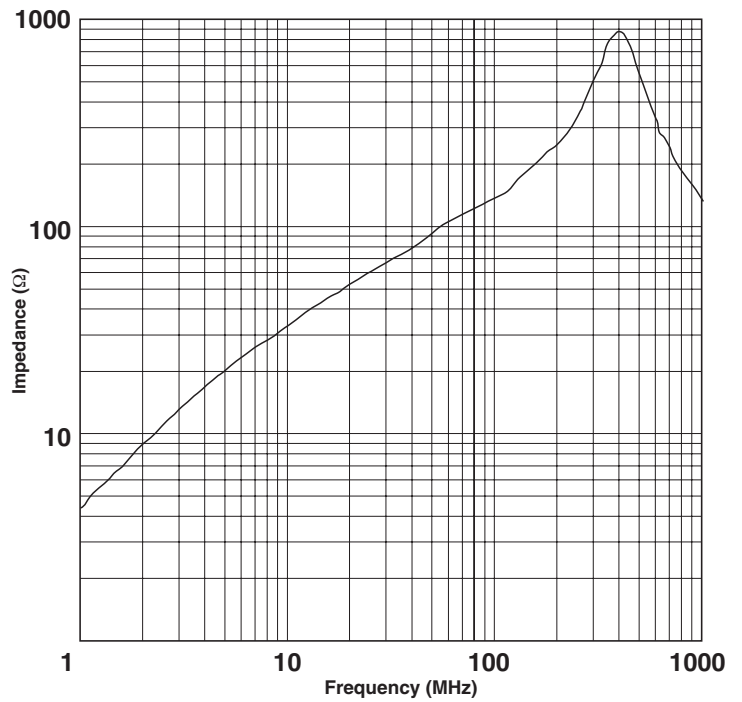

All dimensions shown are standard.  
However, other variations can be made  
upon individual customer request.

# FERRITES

## RIBBON CABLE SPLIT CORES (RFP)

### FEATURES

This family of split suppression cores is used to attenuate irradiated or conducted EMI noises on ribbon cables.

Material: A5.

For performance and mechanical data on these parts please refer to the typical data.

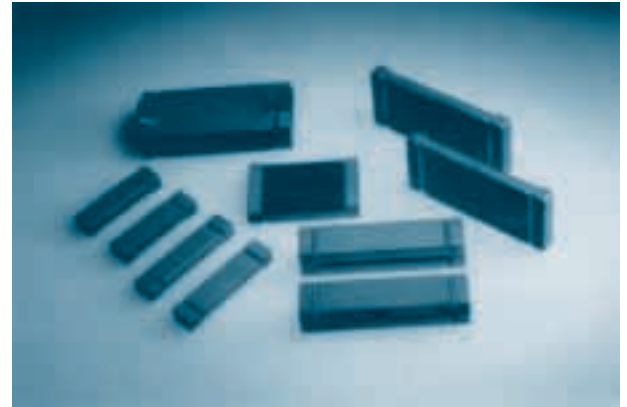

Dimensions in mm.

Part Number	Dimensions					Impedance	
	A	B	C	D	E	25Mhz	100Mhz
RFP1-20-10-A5	38.00	26.60	10.00	6.35	0.80	45	107
RFP1-20-25-A5	38.00	26.60	25.40	6.35	0.80	105	175
RFP1-26-10-A5	45.00	34.40	10.00	6.35	0.80	41	98
RFP1-26-28-A5	45.00	34.40	28.50	6.35	0.80	102	189
RFP1-34-28-A5	55.10	43.70	28.50	6.35	0.80	80	181
RFP1-40-13-A5	63.50	52.00	13.00	6.35	0.80	45	114
RFP1-40-15-A5	63.50	52.00	15.00	6.35	0.80	50	124
RFP1-40-28-A5	63.50	52.00	28.50	6.35	0.80	77	172
RFP1-50-28-A5	76.20	65.30	28.50	6.35	0.80	70	198
RFP2-10-10-A5	16.50	12.50	10.25	2.00	0.60	31	75
RFP2-20-12-A5	32.00	27.00	12.00	2.10	0.40	30	87
RFP3-16-12-A5	25.00	1.00	10.25	2.80	1.10	28	90

**ORDERING CODE**  
**RFP - 1 - 26 - 28 - A5**  
 (1) (2) (3) (4) (5)

- (1) PART NO.
- (2) SHAPE
- (3) RIBBON CONDUCTOR NO.  
(PITCH 1.27mm)
- (4) C DIM.
- (5) MATERIAL
- (6) LOCKING CLAMP: M=RMC-01  
LOCKING SPRING: S=RMS-01

Other sizes are available upon request

Impedance figures are typical values.

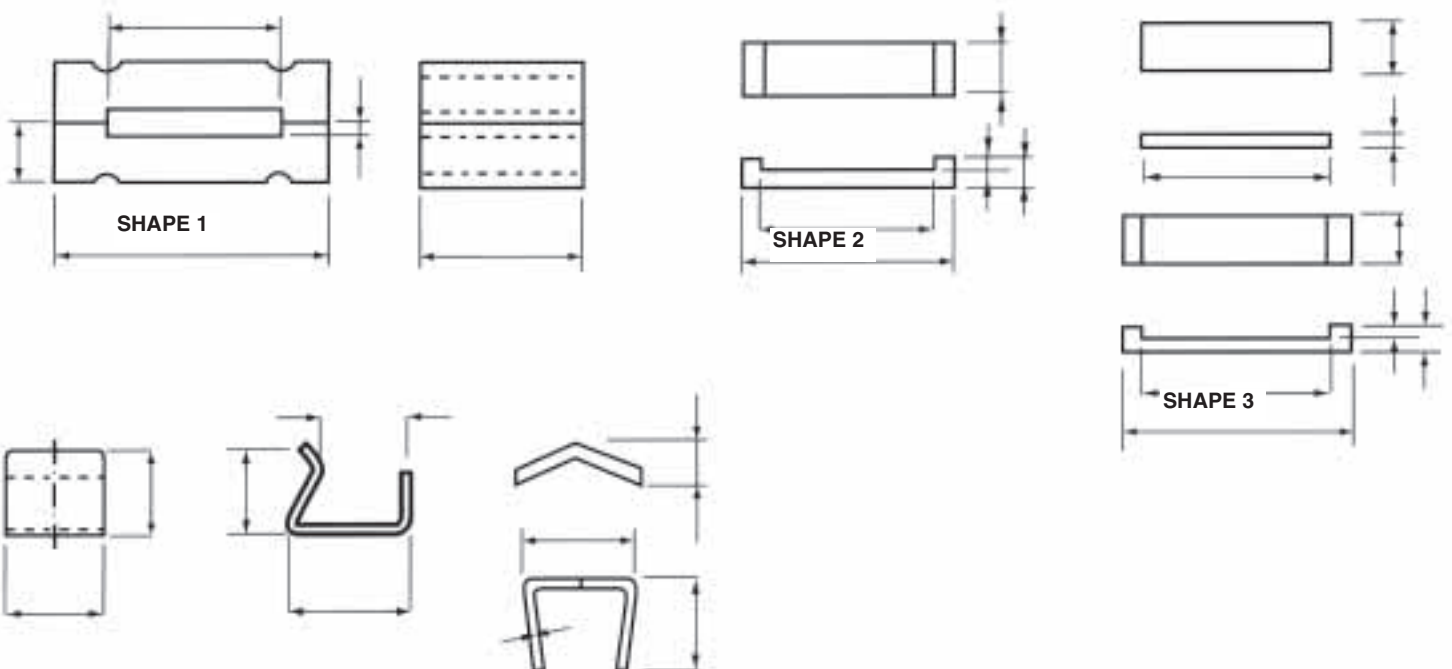

# FERRITES

## RIBBON CABLE SPLIT CORES (RFP)

### TYPICAL DATA

#### RFP1-20-25

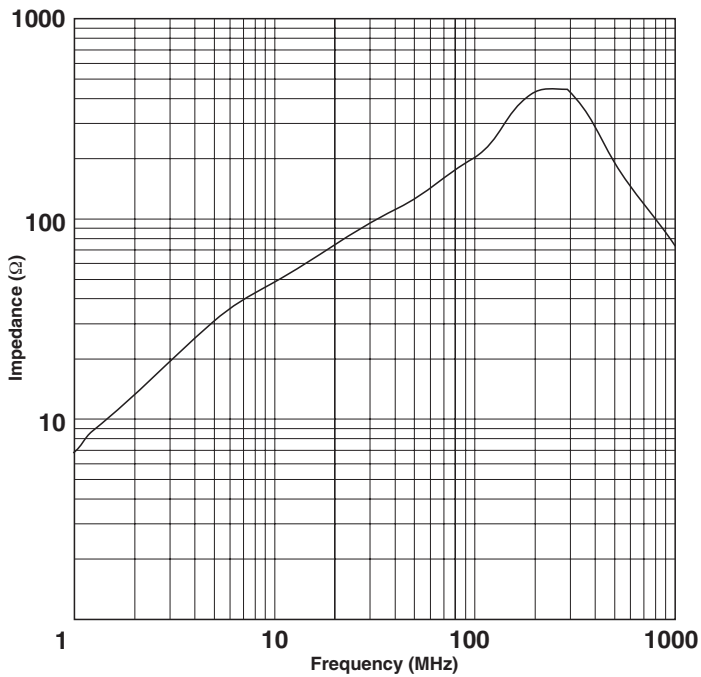

#### RFP1-26-28

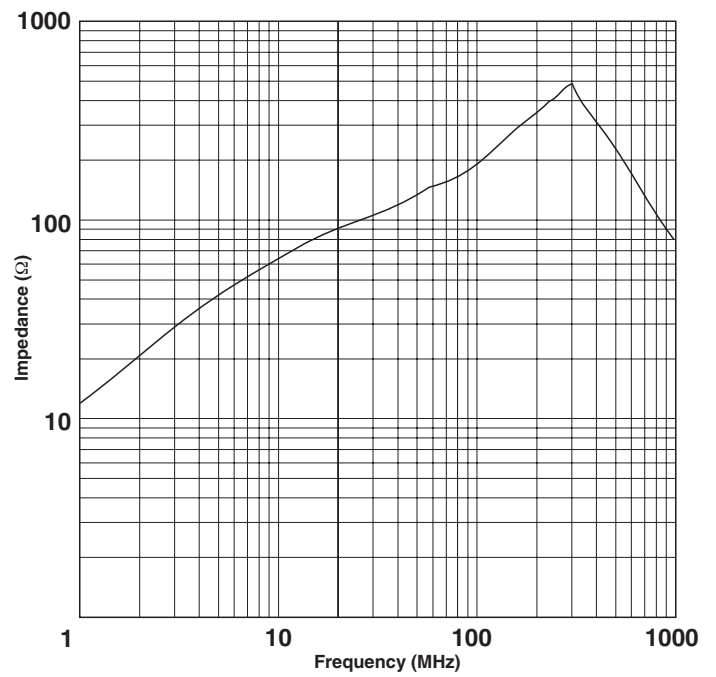

#### RFP1-34-28

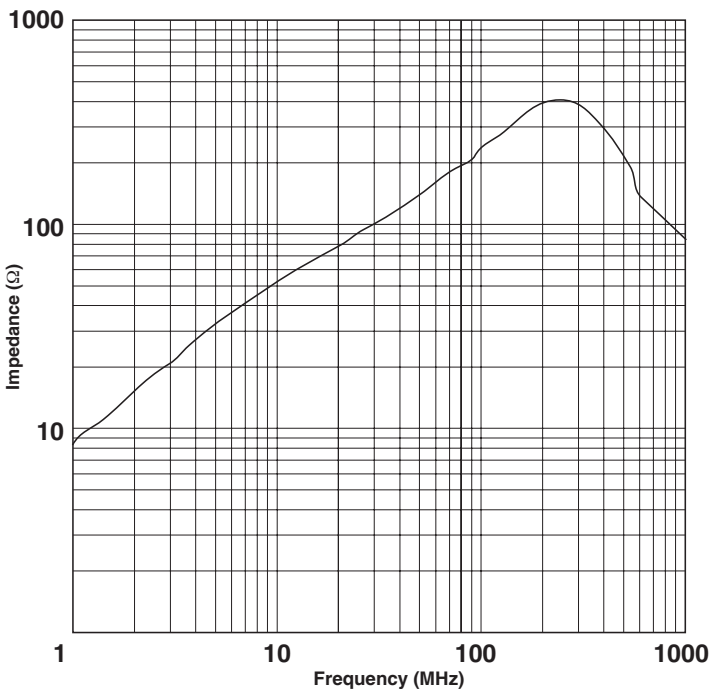

#### RFP1-40-28

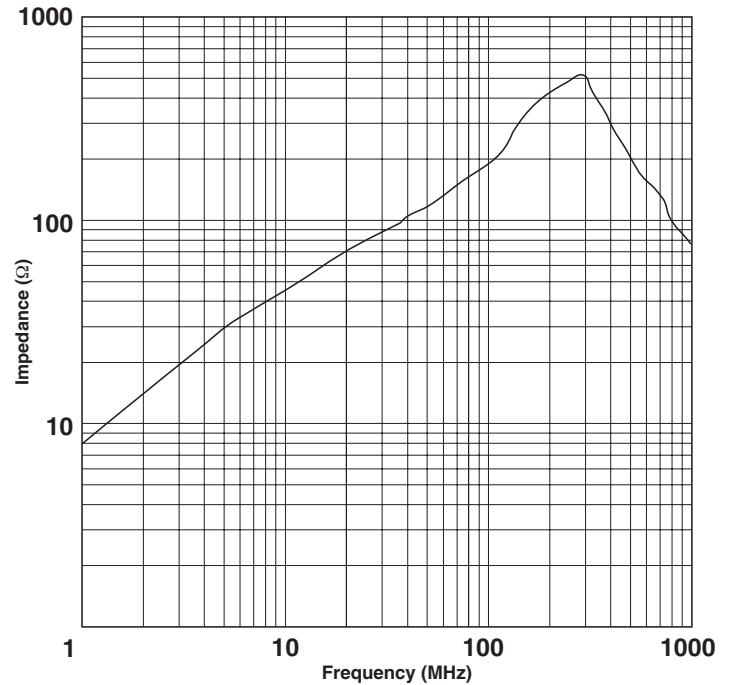

All dimensions shown are standard.  
However, other variations can be made  
upon individual customer request.

# FERRITES

## SPLIT SLEEVE CORES WITH PLASTIC CASE (RKCF)

### FEATURES

These products are used as suppression cores for round cable and are available for a wide range of cable diameters.

Installed around a cable, these A5 material cores, attenuate any form of EMI emission.

The nylon case makes the assembly of the core halves a snap. Cores are easily installed in equipment where retrofit and test are a necessity. Impedance values are based upon single turn measurements.



Material: A5

Plastic Case Material: PA66 (NYLON) 94V-0

For performance and mechanical data on these parts refer to the typical data.

*Dimensions in mm.*

Part Number	Dimension				Impedance		Cable diameter	
	A	B	C	D	25 Mhz	100 Mhz	from	to
<b>RKCF-05-A5</b>	<b>14.00</b>	<b>5.00</b>	<b>14.70</b>	<b>23.30</b>	<b>103</b>	<b>174</b>	<b>4.5</b>	<b>5.0</b>
<b>RKCF-06-A5</b>	<b>19.80</b>	<b>6.50</b>	<b>19.20</b>	<b>32.70</b>	<b>133</b>	<b>308</b>	<b>5.5</b>	<b>6.5</b>
<b>RKCF-10-A5</b>	<b>23.20</b>	<b>10.15</b>	<b>23.80</b>	<b>32.60</b>	<b>124</b>	<b>245</b>	<b>9.0</b>	<b>10.0</b>
<b>RKCF-13-A5</b>	<b>30.50</b>	<b>13.05</b>	<b>30.30</b>	<b>32.70</b>	<b>137</b>	<b>268</b>	<b>12.0</b>	<b>13.0</b>

*Other sizes are available upon request*

*Impedance figures are typical values.*

### ORDERING CODE

**RKCF - 05 - A5 - BK**

(1) (2) (3) (4)

- (1) PART NO.
- (2) CABLE DIA.
- (3) MATERIAL
- (4) CASE COLOUR

### SHAPE

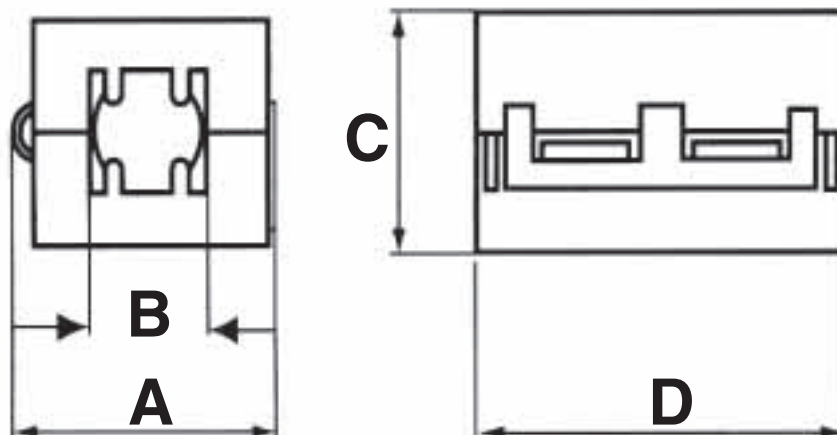

# FERRITES

## SPLIT SLEEVE CORES WITH PLASTIC CASE (RKCF)

### TYPICAL DATA

**RKCF-05-A5**

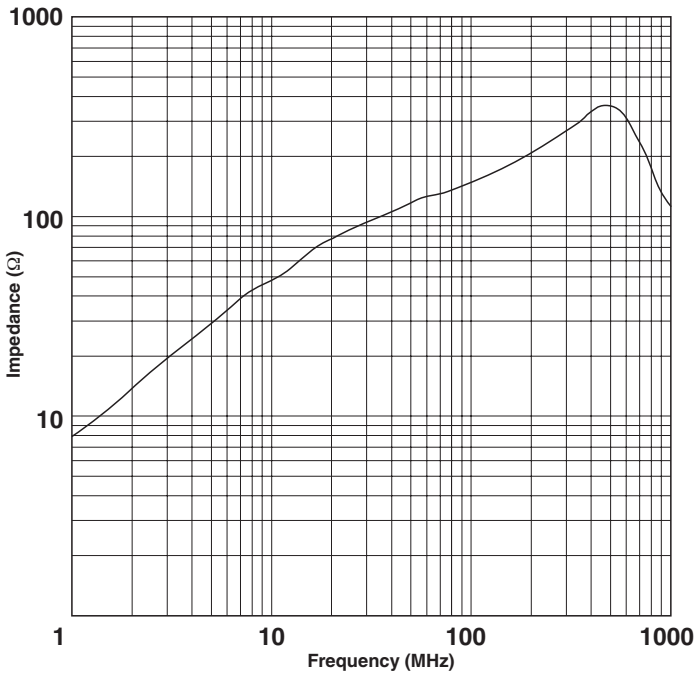

**RKCF-06-A5**

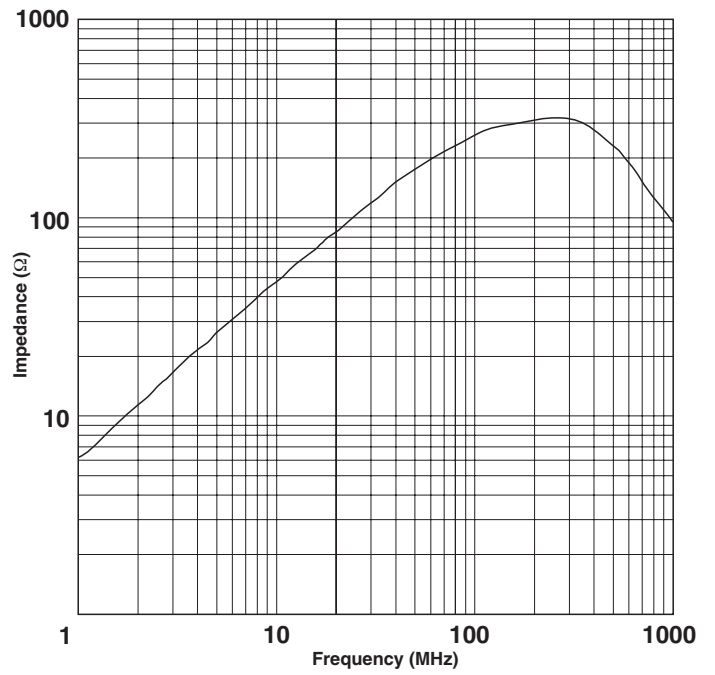

**RKCF-10-A5**

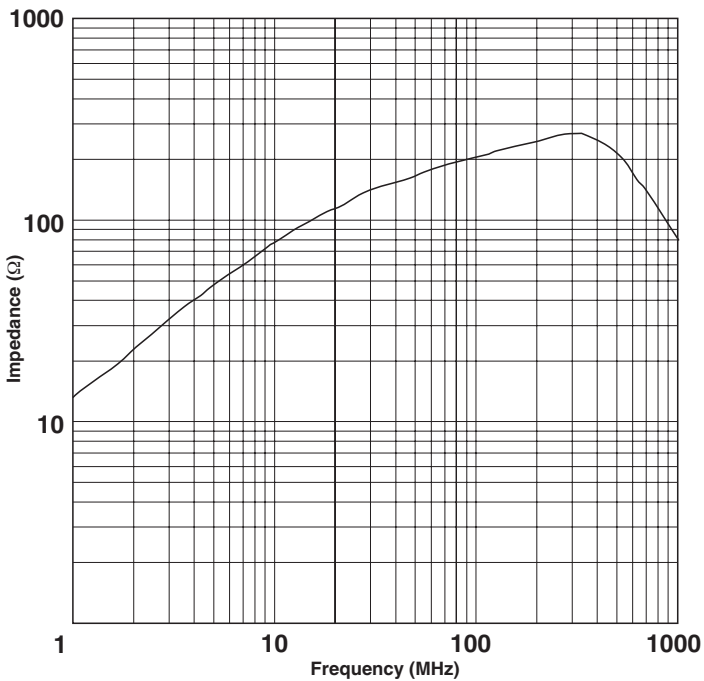

**RKCF-13-A5**

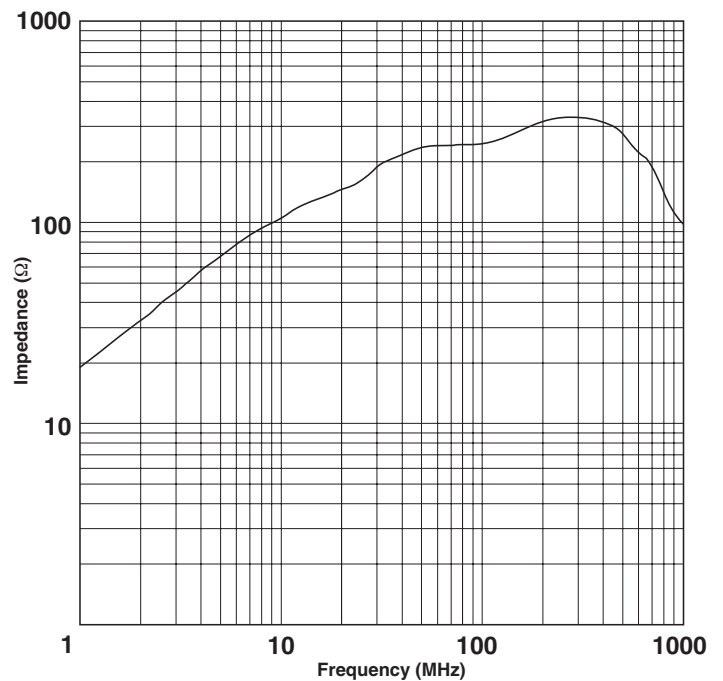

**All dimensions shown are standard.  
However, other variations can be made  
upon individual customer request.**

# FERRITES

## TOROIDAL CORES (RT)

### FEATURES

The ring configuration provides for the ultimate in utilisation of the ferrite material properties.

Materials: A5, A6, K5B.

Can be used across in a wide frequency range.  
The RT type ferrite core is mainly used as a multi-turn suppression core.

For performance and mechanical data on these parts please refer to the typical data.



*Dimensions in mm.*

Part Number	Dimension			Impedance		Part Number	Dimension			Impedance	
	A	B	C	25 Mhz	100 Mhz		A	B	C	25 Mhz	100 Mhz
RT035-008-025	3.50	0.80	2.50	25	52	RT100-060-062	10.00	6.00	6.20	25	49
RT035-008-030	3.50	0.80	3.00	31	53	RT100-070-050	10.00	7.00	5.00	17	39
RT035-012-030	3.50	1.20	3.00	25	45	RT100-070-075	10.00	7.00	7.50	25	46
RT035-013-033	3.50	1.30	3.25	27	48	RT110-050-090	11.00	5.00	9.00	60	107
RT035-018-033	3.50	1.80	3.00	18	37	RT120-060-040	12.00	6.00	4.00	24	48
RT040-020-015	4.00	2.00	1.50	15	35	RT120-060-060	12.00	6.00	6.00	34	58
RT040-020-020	4.00	2.00	2.00	14	37	RT120-060-080	12.00	6.00	8.00	46	77
RT040-020-030	4.00	2.00	3.00	20	41	RT120-070-055	12.00	7.00	5.50	26	49
RT041-016-040	4.10	1.60	4.00	31	55	RT120-070-060	12.00	7.00	6.00	28	48
RT044-028-014	4.40	2.80	1.40	12	32	RT125-080-064	12.50	8.00	6.40	24	46
RT050-020-040	5.00	2.00	4.00	30	46	RT130-070-055	13.00	7.00	5.50	27	50
RT060-030-020	6.00	3.00	2.00	15	35	RT130-070-070	13.00	7.00	7.00	32	56
RT060-030-030	6.00	3.00	3.00	21	40	RT130-071-127	13.00	7.10	12.70	60	106
RT060-030-040	6.00	3.00	4.00	24	44	RT140-080-050	14.00	8.00	5.00	26	50
RT065-043-060	6.50	4.30	6.00	21	42	RT140-080-070	14.00	8.00	7.00	28	50
RT073-033-043	7.30	3.30	4.30	27	50	RT142-064-102	14.20	6.35	10.20	57	95
RT080-031-040	8.00	3.10	4.00	33	52	RT142-064-135	14.20	6.35	13.50	75	125
RT080-040-040	8.00	4.00	4.00	23	46	RT142-070-150	14.20	7.00	15.00	82	122
RT085-050-030	8.50	5.00	3.00	16	34	RT142-080-120	14.20	8.00	12.00	49	76
RT090-050-030	9.00	5.00	3.00	16	37	RT145-102-080	14.50	10.20	8.00	29	69
RT090-050-080	9.00	5.00	8.00	38	64	RT150-105-120	15.00	10.50	12.00	37	62
RT095-046-046	9.50	4.60	4.57	27	47	RT159-079-142	15.88	7.87	14.20	79	121
RT095-048-033	9.50	4.80	3.30	22	45	RT160-090-120	16.00	9.00	12.00	55	87
RT095-050-048	9.50	5.00	4.80	22	47	RT160-100-100	16.00	10.00	10.00	43	85
RT095-050-050	9.50	5.00	5.00	26	49	RT160-120-080	16.00	12.00	8.00	26	48
RT100-030-060	10.00	3.00	6.00	50	82	RT160-120-150	16.00	12.00	15.00	33	58
RT100-050-050	10.00	5.00	5.00	34	73	RT165-082-130	16.50	8.20	13.00	70	125
RT100-060-040	10.00	6.00	4.00	20	42	RT165-082-160	16.50	8.20	16.00	83	140

*Other sizes are available upon request*

*Impedance figures are typical values.*



# FERRITES TOROIDAL CORES (RT)

Dimensions in mm.

Part Number	Dimension			Impedance		Part Number	Dimension			Impedance	
	A	B	C	25 Mhz	100 Mhz		A	B	C	25 Mhz	100 Mhz
RT165-092-075	16.50	9.20	7.50	35	70	RT225-138-064	22.50	13.80	6.40	25	47
RT175-080-100	17.50	8.00	10.00	62	94	RT225-138-127	22.50	13.80	12.70	46	71
RT175-095-064	17.50	9.50	6.35	31	53	RT236-114-140	23.60	11.40	14.00	80	133
RT175-095-127	17.50	9.50	12.70	59	95	RT236-150-114	23.60	15.00	11.40	43	85
RT175-095-150	17.50	9.50	15.00	70	113	RT250-150-080	25.00	15.00	8.00	38	79
RT175-107-080	17.50	10.70	8.00	33	60	RT250-150-100	25.00	15.00	10.00	44	87
RT180-100-060	18.00	10.00	6.00	31	55	RT250-150-120	25.00	15.00	12.00	53	97
RT180-100-100	18.00	10.00	10.00	47	77	RT254-127-064	25.40	12.70	6.35	39	80
RT187-102-143	18.67	10.16	14.27	70	119	RT259-128-213	25.91	12.80	21.30	106	174
RT187-102-170	18.67	10.16	17.02	75	125	RT260-130-127	26.00	13.00	12.70	74	125
RT190-100-100	19.00	10.00	10.00	54	102	RT280-160-075	28.00	16.00	7.50	33	59
RT190-120-080	19.00	12.00	8.00	32	72	RT280-160-130	28.00	16.00	13.00	55	100
RT190-120-100	19.00	12.00	10.00	37	78	RT280-160-170	28.00	16.00	17.00	71	120
RT200-100-050	20.00	10.00	5.00	28	68	RT280-160-200	28.00	16.00	20.00	85	155
RT200-120-100	20.00	12.00	10.00	40	68	RT290-190-075	29.00	19.00	7.50	26	70
RT205-102-100	20.50	10.20	10.00	53	86	RT310-190-070	31.00	19.00	7.00	35	77
RT212-127-060	21.20	12.70	6.00	27	52	RT310-190-080	31.00	19.00	8.00	30	55
RT220-135-064	22.00	13.50	6.40	28	53	RT310-190-160	31.00	19.00	16.00	68	115
RT220-135-080	22.00	13.50	8.00	37	78	RT310-190-222	31.00	19.00	22.20	88	146
RT220-140-100	22.00	14.00	10.00	42	90	RT360-250-070	36.00	25.00	7.00	23	63
RT221-137-127	22.10	13.72	12.70	48	83	RT406-274-150	40.60	27.40	15.00	55	106
RT225-135-064	22.50	13.50	6.35	30	54	RT614-360-128	61.40	36.00	12.80	58	104

Other sizes are available upon request

Impedance figures are typical values.

## ORDERING CODE

**RT - 120 - 060 - 080 - A5**  
(1) (2) (3) (4) (5)

- (1) PART NO.
- (2) CORE OD.
- (3) CORE ID.
- (4) CORE LENGTH
- (5) MATERIAL

## SHAPE

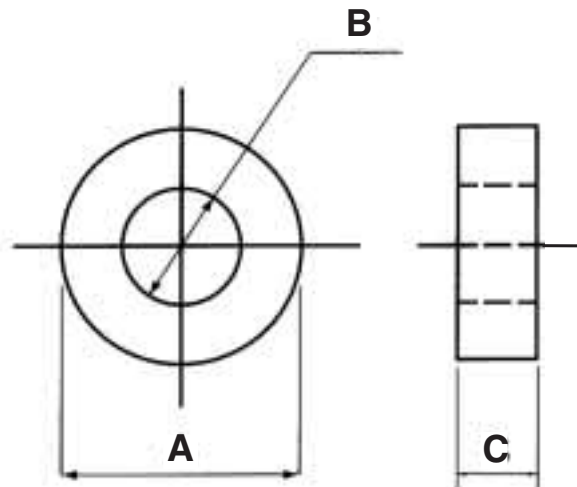

# FERRITES TOROIDAL CORES (RT)

## TYPICAL DATA

### RT035-008-025

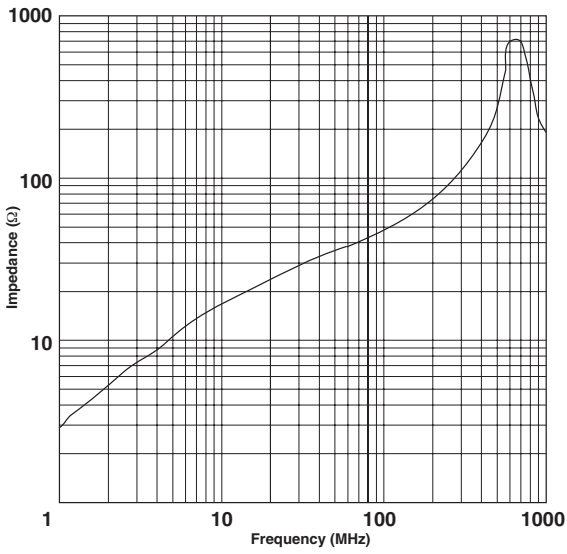

### RT035-018-033

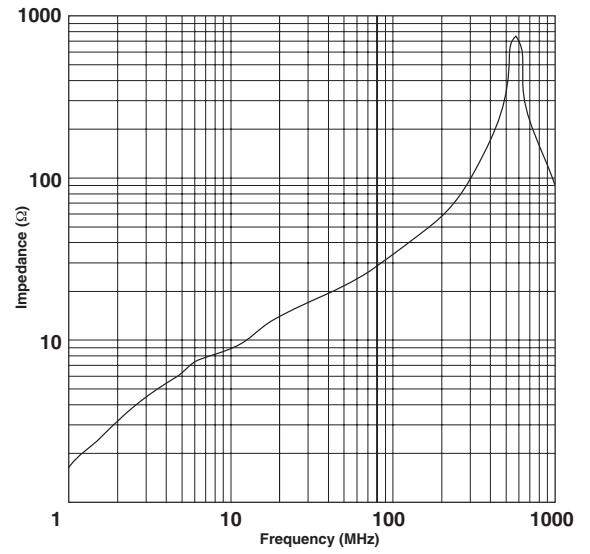

### RT040-020-020

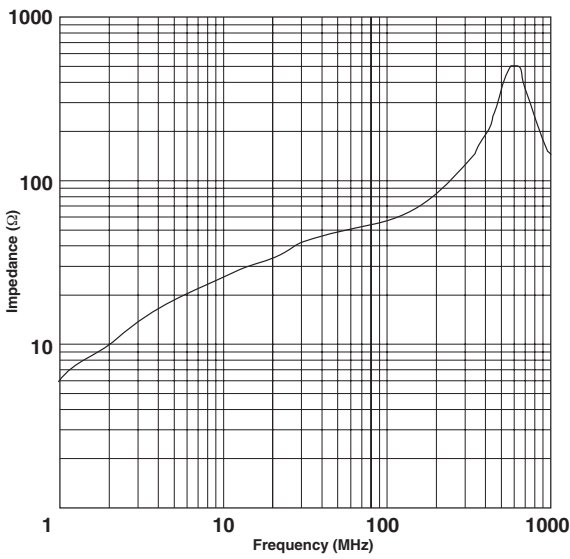

### RT060-030-030

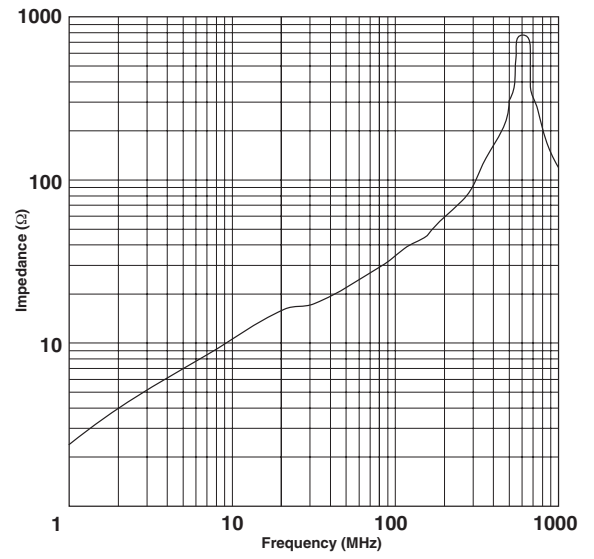

### RT080-040-040

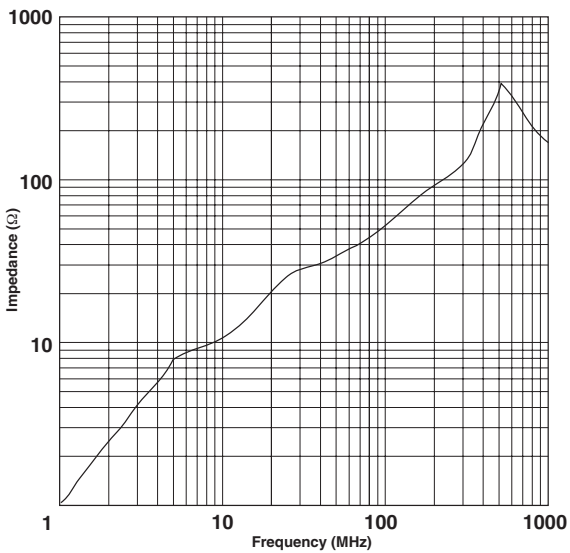

### RT090-050-080

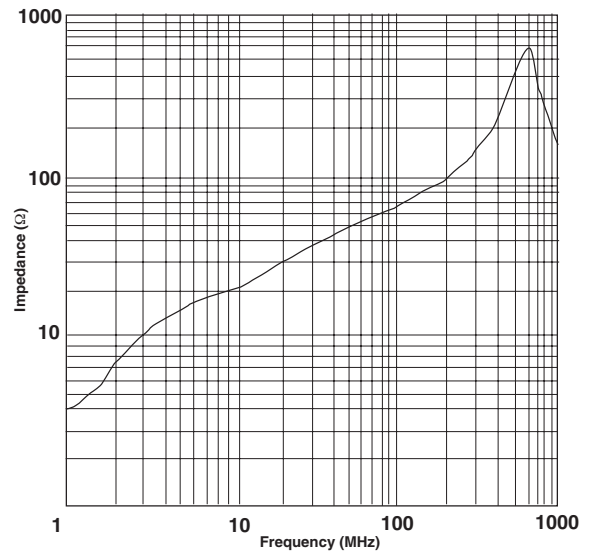

# FERRITES TOROIDAL CORES (RT)

## TYPICAL DATA

**RT095-050-048**

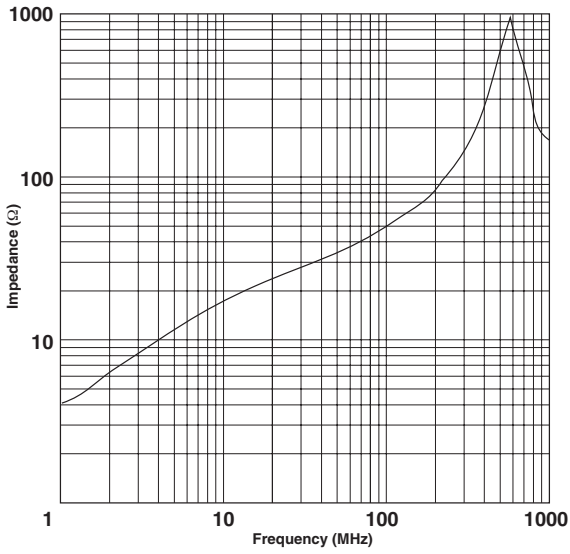

**RT095-050-050**

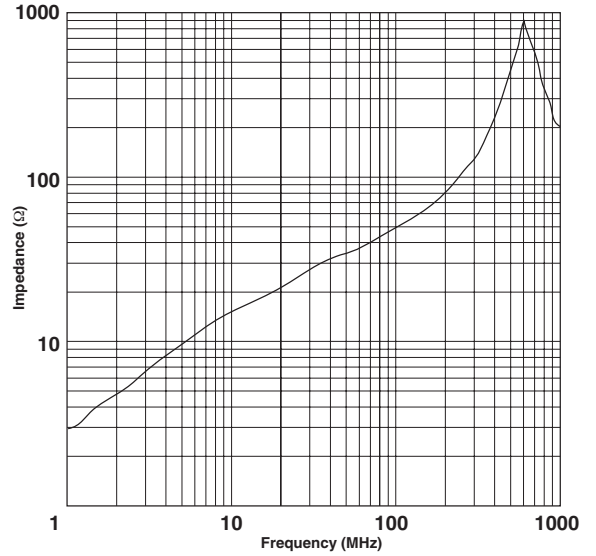

**RT100-060-040**

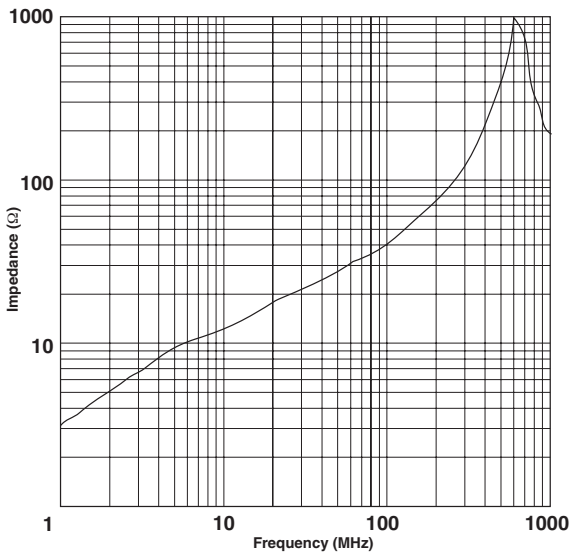

**RT120-060-040**

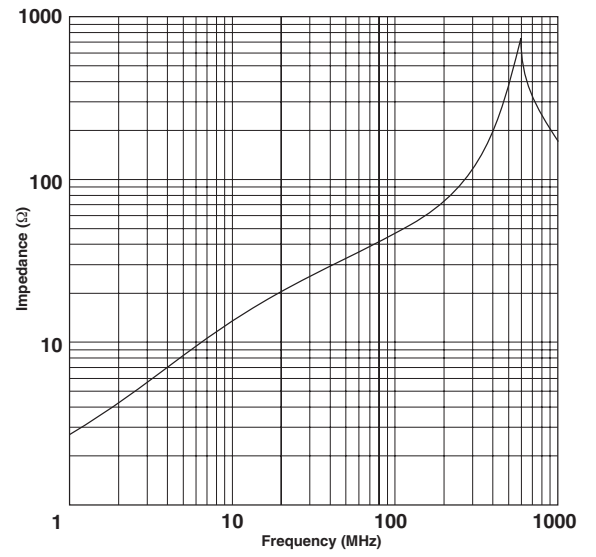

**RT130-070-070**

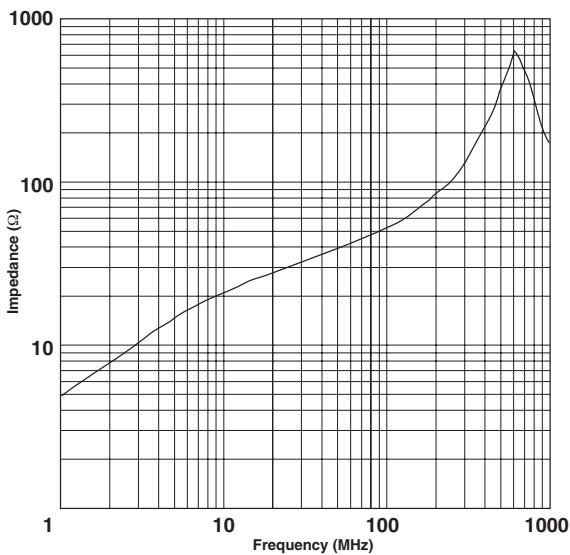

**RT142-080-120**

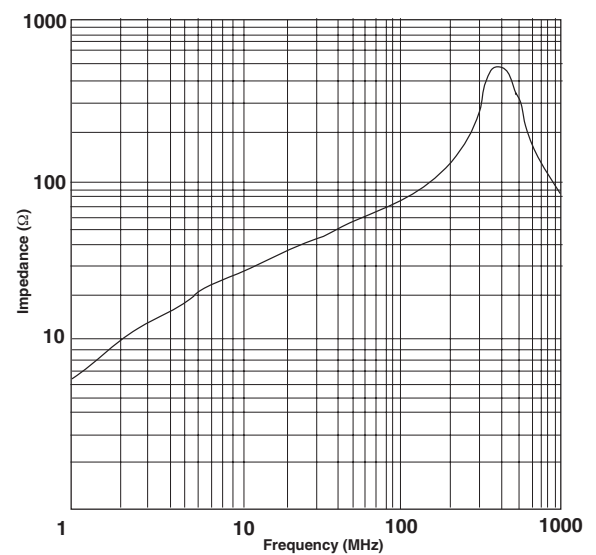

# FERRITES TOROIDAL CORES (RT)

## TYPICAL DATA

### RT145-102-080

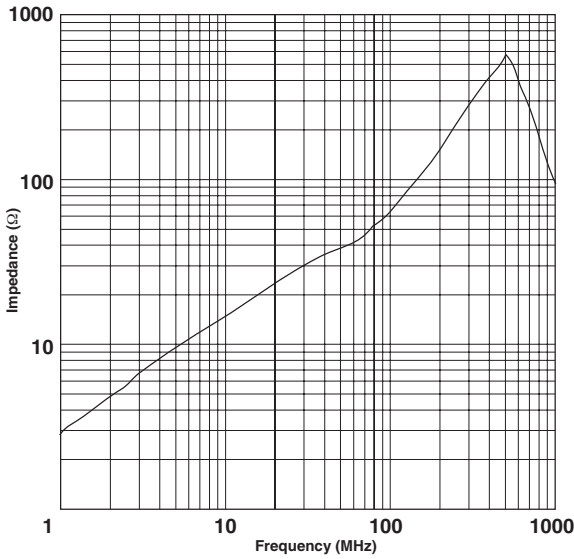

### RT165-082-160

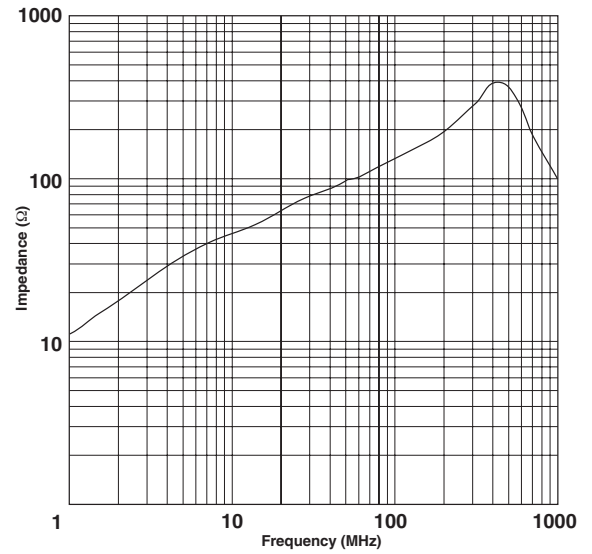

### RT175-095-127

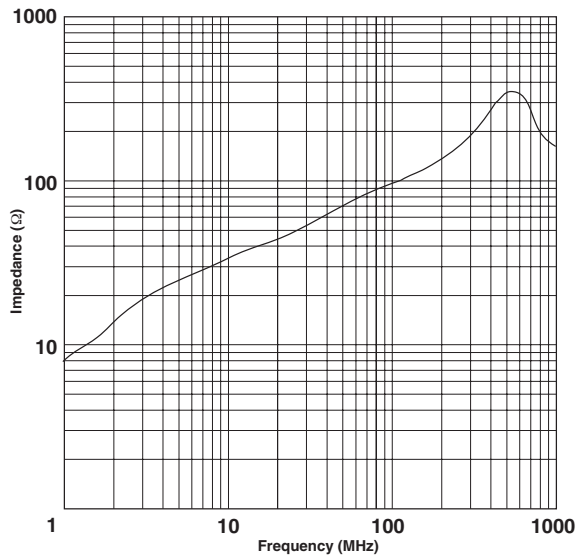

### RT187-102-170

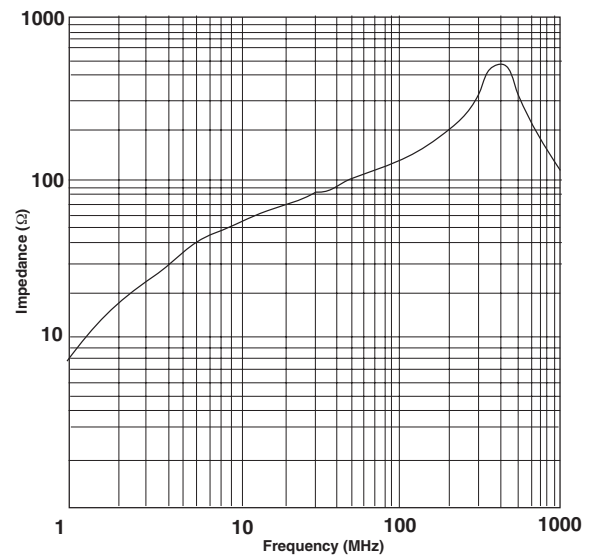

### RT205-102-100

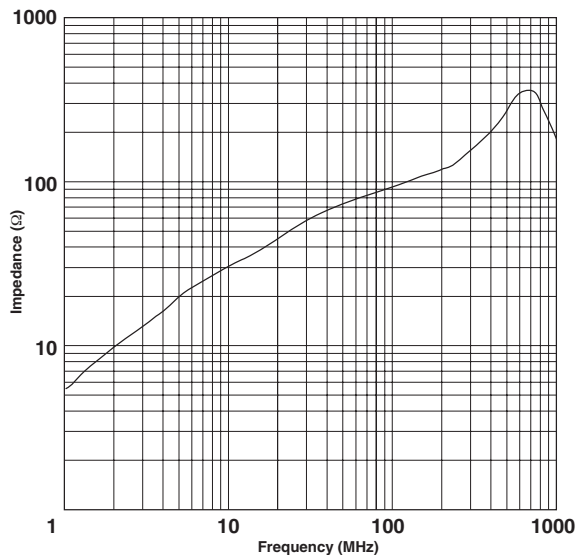

### RT221-137-127

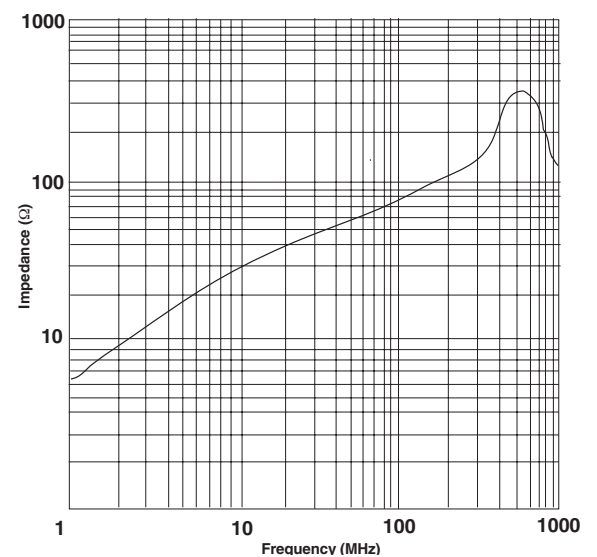

# FERRITES TOROIDAL CORES (RT)

## TYPICAL DATA

### RT225-138-127

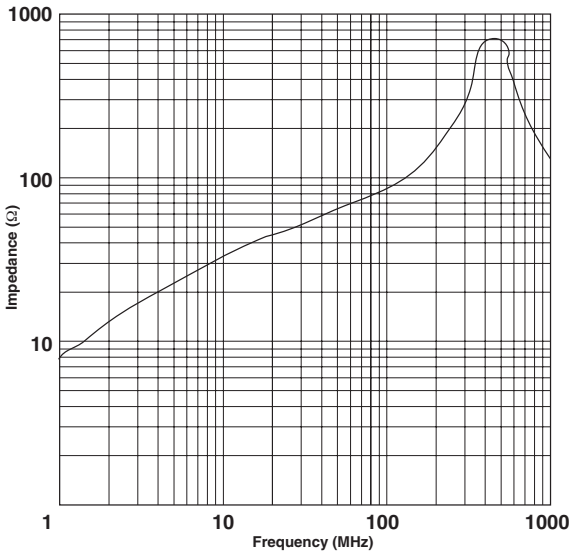

### RT250-150-120

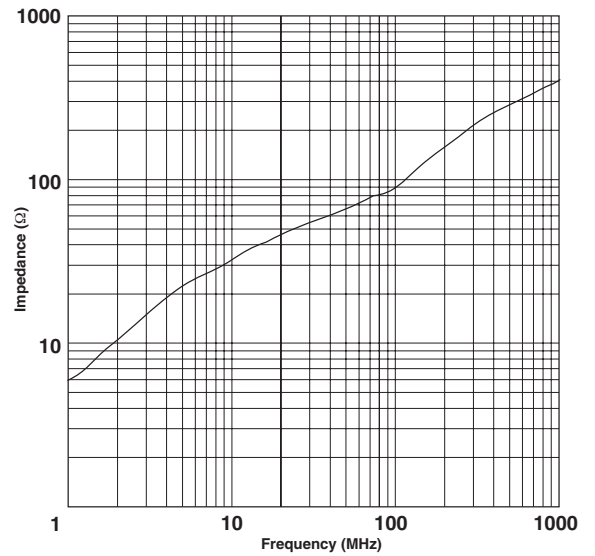

### RT280-160-130

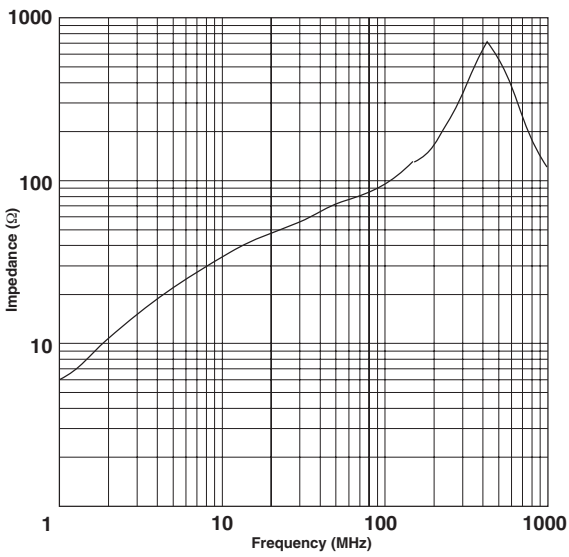

### RT310-190-080

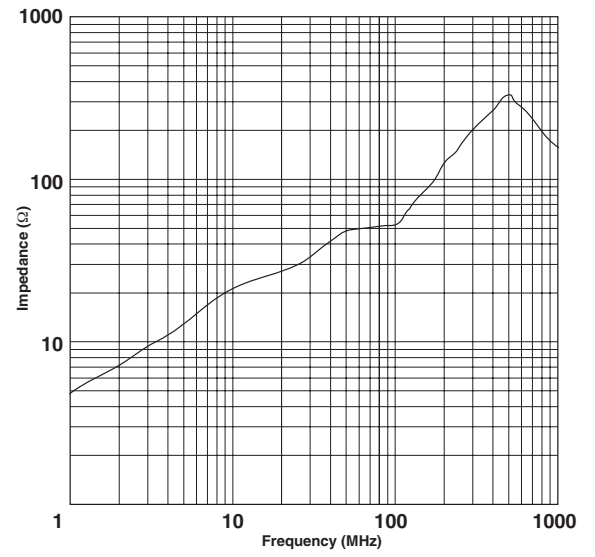

### RT406-274-150

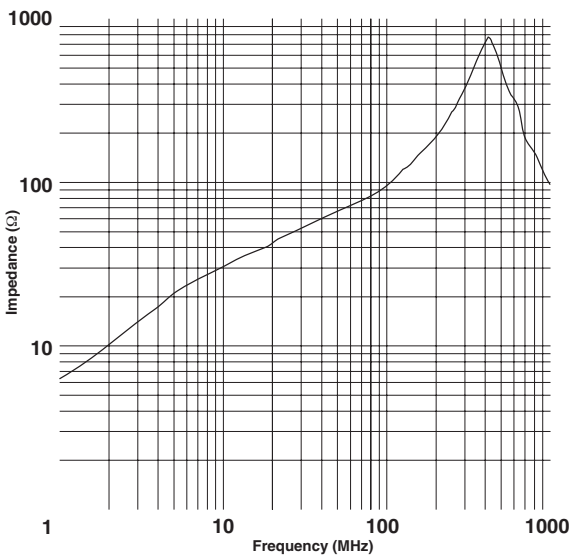

### RT614-360-128

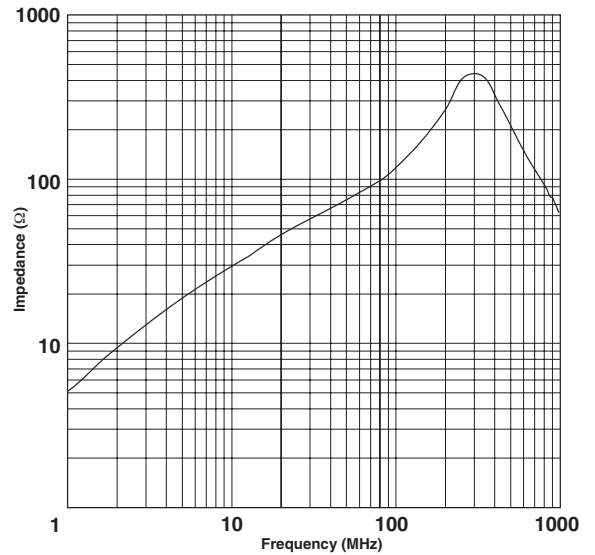

# FERRITES

## FLAT CABLE SLEEVE CORES (RFS)

### FEATURES

This family of suppression cores is used to attenuate irradiated or conducted EMI noises on ribbon cables.

Material: A5.

For performance and mechanical data on these parts please refer to the typical data.



Dimensions in mm.

Part Number	Dimensions					Impedance	
	A	B	C	D	E	25Mhz	100Mhz
RFS1-15-07-A5	23.30	20.00	7.00	3.00	0.90	17	45
RFS1-15-12-A5	23.30	20.00	12.00	3.00	0.90	23	58
RFS1-21-25-A5	38.53	26.77	25.40	12.06	1.90	100	180
RFS1-27-12-A5	38.50	35.00	12.00	4.00	0.80	25	68
RFS1-38-13-A5	60.00	48.50	12.70	12.00	2.20	40	95
RFS2-09-08-A5	16.00	11.50	8.00	5.35	0.50	29	72
RFS2-09-12-A5	16.00	11.50	12.00	5.35	0.50	41	73
RFS2-09-20-A5	16.00	11.50	20.00	5.35	0.50	60	120
RFS2-02-30-A5	24.00	16.00	30.00	12.00	4.00	120	200
RFS2-14-13-A5	23.80	18.70	12.50	6.30	1.10	46	96
RFS2-15-12-A5	24.50	20.00	12.00	5.00	0.30	35	70
RFS2-18-08-A5	28.50	23.50	8.00	6.50	0.83	28	65
RFS2-20-12-A5	31.00	27.00	12.00	5.00	1.00	28	75
RFS2-21-08-A5	33.50	27.00	8.00	6.50	1.30	21	53
RFS2-21-10-A5	33.50	27.00	10.00	6.50	1.30	26	57
RFS2-21-12-A5	33.50	27.00	12.00	6.50	1.30	30	66
RFS2-21-15-A5	33.50	27.00	15.00	6.50	1.30	36	78
RFS2-21-20-A5	33.50	27.00	20.00	6.50	1.30	58	149
RFS2-27-08-A5	40.00	35.00	8.00	6.50	1.30	23	58
RFS2-27-10-A5	40.00	35.00	10.00	6.50	1.30	25	64
RFS2-27-12-A5	40.00	35.00	12.00	6.50	1.30	28	69
RFS2-27-15-A5	40.00	35.00	15.00	6.50	1.30	32	85
RFS2-30-12-A5	45.20	40.00	12.00	6.50	1.30	27	70
RFS2-30-15-A5	45.20	40.00	15.00	6.50	1.30	31	70
RFS2-34-12-A5	49.60	44.00	12.00	6.50	1.30	25	66
RFS2-40-12-A5	57.60	52.00	12.00	6.50	1.30	25	75

Other sizes are available upon request

Impedance figures are typical values.

### ORDERING CODE

**RFS - 2 - 21 - 20 - A5**  
(1) (2) (3) (4) (5)

- (1) PART NO.
- (2) SHAPE
- (3) RIBBON CONDUCTOR NO.  
(PITCH 1.27mm)
- (4) C DIM.
- (5) MATERIAL

### SHAPE

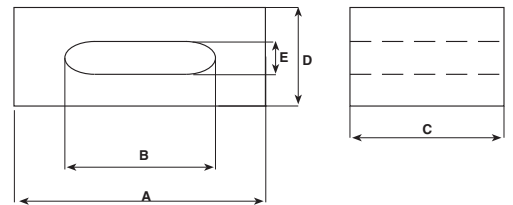

SHAPE 1

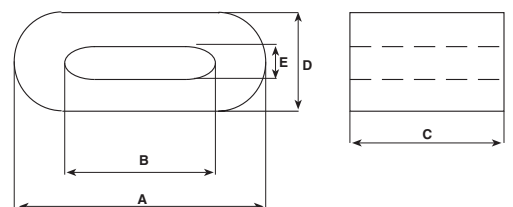

SHAPE 2

# FERRITES

## FLAT CABLE SLEEVE CORES (RFS)

### TYPICAL DATA

**RFS1-15-07**

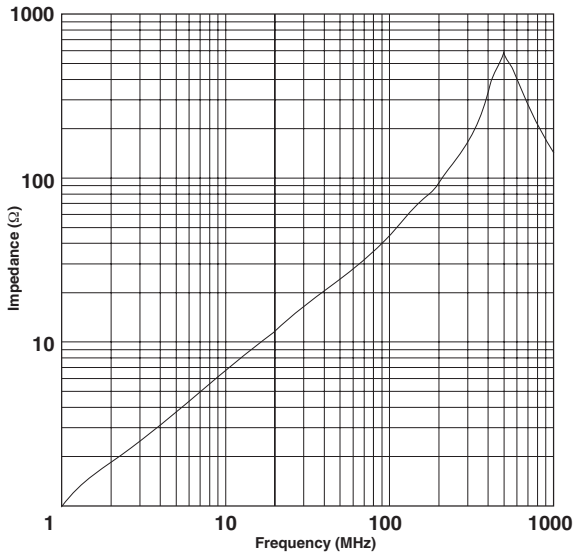

**RFS1-38-12**

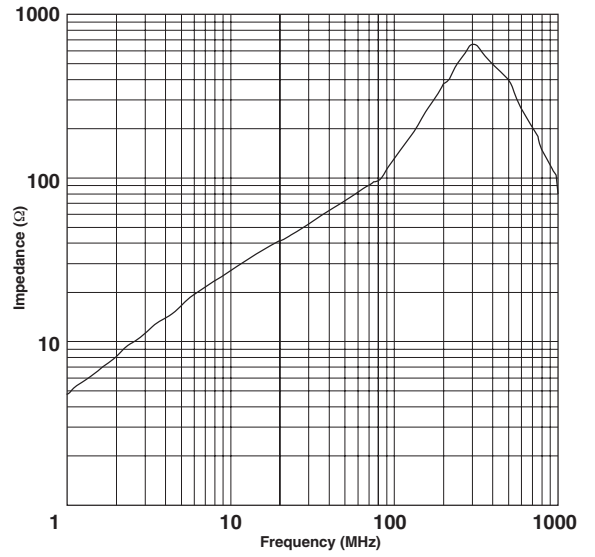

**RFS2-20-12**

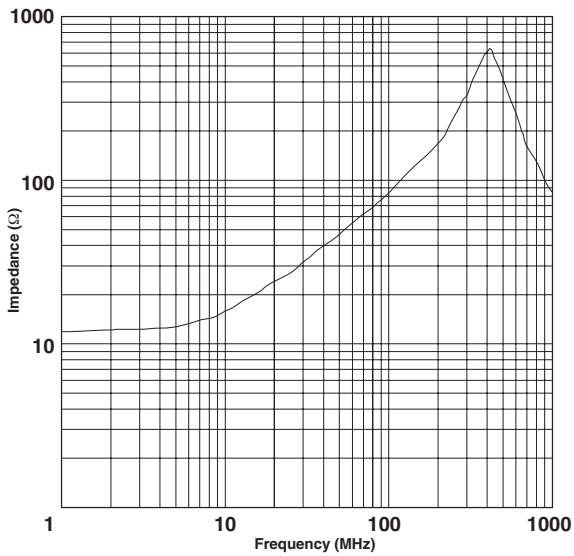

**RFS2-21-08**

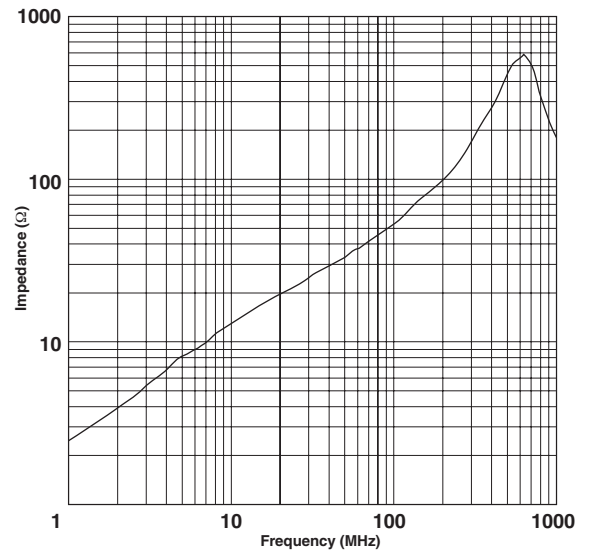

**RFS2-27-12**

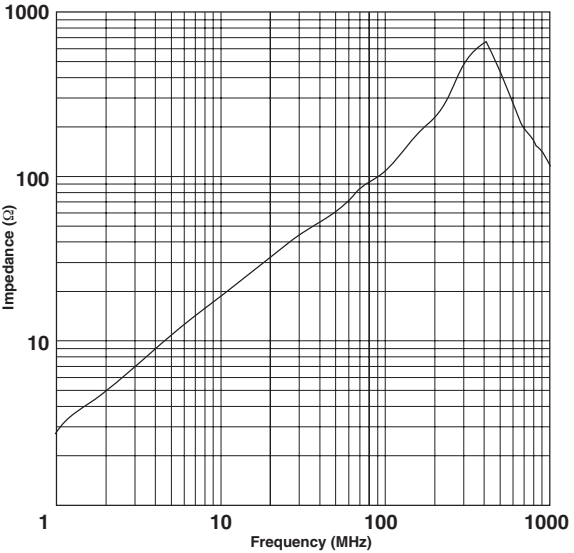

**RFS2-30-12**

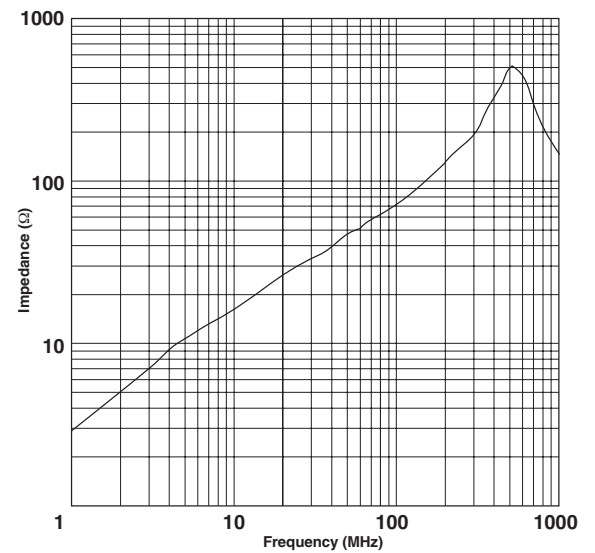

# FERRITES

## BEAD CORES (RRH)

### FEATURES

Bead cores are a broad selection of shielding beads that guarantee impedance specification over a wide frequency range.

Materials: A5, A6, K5B.

The RRH series of bead cores mainly have applications on wire assemblies and the MATV CATV industries.

For performance and mechanical data on these parts please refer to the typical data.



*Dimensions in mm.*

Part Number	Dimension			Impedance		Part Number	Dimension			Impedance	
	A	B	C	25 Mhz	100 Mhz		A	B	C	25 Mhz	100 Mhz
RRH025-008-040	2.50	0.80	4.00	33	52	RRH075-024-075	7.50	2.40	7.50	60	102
RRH030-010-030	3.00	1.00	3.00	25	47	RRH079-030-100	7.90	3.00	10.00	68	79
RRH030-012-030	3.00	1.20	3.00	23	44	RRH079-030-190	7.90	3.00	19.00	130	190
RRH035-008-140	3.50	0.80	14.00	144	212	RRH079-040-128	7.90	4.00	12.80	66	107
RRH035-010-080	3.50	1.00	8.00	78	111	RRH080-032-101	8.00	3.18	10.06	67	115
RRH035-012-040	3.50	1.20	4.00	31	46	RRH080-060-098	8.00	6.00	9.80	35	55
RRH035-012-050	3.50	1.20	5.00	37	55	RRH093-045-095	9.30	4.50	9.50	53	98
RRH035-012-060	3.50	1.20	6.00	45	73	RRH095-050-104	9.50	5.00	10.40	53	81
RRH035-012-070	3.50	1.20	7.00	54	84	RRH095-050-145	9.50	5.00	14.50	75	121
RRH035-013-050	3.50	1.30	5.00	37	61	RRH095-050-159	9.50	5.00	15.88	74	103
RRH035-013-060	3.50	1.30	6.00	42	72	RRH095-050-190	9.50	5.00	19.00	95	135
RRH035-013-090	3.50	1.30	9.00	62	80	RRH095-050-195	9.50	5.00	19.50	98	153
RRH035-015-060	3.50	1.50	6.00	35	60	RRH095-052-095	9.50	5.20	9.50	45	76
RRH035-018-050	3.50	1.80	5.00	27	48	RRH095-052-100	9.50	5.20	10.00	48	74
RRH040-020-040	4.00	2.00	4.00	24	48	RRH095-058-100	9.50	5.80	10.00	38	68
RRH040-020-050	4.00	2.00	5.00	28	51	RRH098-008-114	9.80	0.80	11.40	167	256
RRH040-020-070	4.00	2.00	7.00	40	64	RRH098-067-135	9.80	6.70	13.50	43	91
RRH040-020-100	4.00	2.00	10.00	53	80	RRH100-050-100	10.00	5.00	10.00	54	85
RRH045-026-120	4.50	2.60	12.00	49	72	RRH100-060-100	10.00	6.00	10.00	38	66
RRH048-023-064	4.83	2.29	6.35	43	80	RRH100-060-140	10.00	6.00	14.00	45	73
RRH050-015-110	5.00	1.50	11.00	93	150	RRH100-070-100	10.00	7.00	10.00	31	57
RRH050-022-180	5.00	2.15	18.00	128	147	RRH105-055-200	10.50	5.50	20.00	95	135
RRH050-023-050	5.00	2.30	5.00	30	55	RRH110-050-185	11.00	5.00	18.50	113	178
RRH060-030-100	6.00	3.00	10.00	52	90	RRH110-050-250	11.00	5.00	25.00	145	230
RRH060-032-180	6.00	3.15	18.00	100	155	RRH115-043-200	11.50	4.30	20.00	148	210
RRH064-033-127	6.35	3.30	12.70	67	105	RRH115-043-260	11.50	4.30	26.00	190	270
RRH064-033-158	6.35	3.30	15.80	76	125	RRH120-035-230	12.00	3.50	23.00	210	328
RRH065-043-100	6.50	4.30	10.00	34	62	RRH120-056-200	12.00	5.60	20.00	119	175

*Other sizes are available upon request*

*Impedance figures are typical values.*



# FERRITES BEAD CORES (RRH)

Dimensions in mm.

Part Number	Dimension			Impedance		Part Number	Dimension			Impedance	
	A	B	C	25 Mhz	100 Mhz		A	B	C	25 Mhz	100 Mhz
RRH120-056-300	12.00	5.60	30.00	180	260	RRH160-090-170	16.00	9.00	17.00	61	115
RRH120-070-150	12.00	7.00	15.00	60	92	RRH160-090-200	16.00	9.00	20.00	98	124
RRH120-085-150	12.00	8.50	15.00	45	85	RRH160-090-280	16.00	9.00	28.00	104	178
RRH123-049-254	12.32	4.88	25.40	172	264	RRH160-090-285	16.00	9.00	28.50	105	195
RRH125-080-125	12.50	8.00	12.50	42	72	RRH160-100-280	16.00	10.00	28.00	91	156
RRH127-079-127	12.70	7.90	12.70	43	60	RRH171-088-254	17.07	8.76	25.40	122	180
RRH142-070-150	14.20	7.00	15.00	78	116	RRH175-083-285	17.50	8.30	28.50	148	242
RRH142-070-235	14.20	7.00	23.50	127	204	RRH175-095-285	17.50	9.50	28.50	115	170
RRH142-070-285	14.20	7.00	28.50	143	243	RRH175-095-350	17.50	9.50	35.00	152	253
RRH142-080-150	14.20	8.00	14.20	63	107	RRH175-100-400	17.50	10.00	40.00	132	232
RRH142-080-285	14.20	8.00	14.20	128	195	RRH175-107-285	17.50	10.70	28.50	90	150
RRH149-070-190	14.99	6.99	19.00	107	171	RRH180-100-280	18.00	10.00	28.00	124	209
RRH149-070-279	14.99	7.00	27.94	151	237	RRH180-100-290	18.00	10.00	29.00	128	210
RRH153-080-280	15.25	8.00	28.00	122	180	RRH186-102-250	18.60	10.00	25.00	115	178
RRH153-100-285	15.25	10.00	28.50	81	128	RRH190-130-290	19.00	13.00	29.00	60	105
RRH157-070-286	15.65	6.99	28.57	164	258	RRH190-058-315	19.00	5.80	31.50	291	423
RRH158-079-160	15.80	7.90	16.00	74	117	RRH259-128-286	25.91	12.83	28.57	127	195
RRH159-079-286	15.88	7.87	28.57	148	241	RRH285-138-286	28.50	13.77	28.57	158	250
RRH160-070-280	16.00	7.00	28.00	147	247						

Impedance figures are typical values.

Other sizes are available upon request

## ORDERING CODE

RRH - 110 - 050 - 185 - A5

(1) (2) (3) (4) (5)

- (1) PART NO.
- (2) CORE OD.
- (3) CORE ID.
- (4) CORE LENGTH
- (5) MATERIAL

## SHAPE

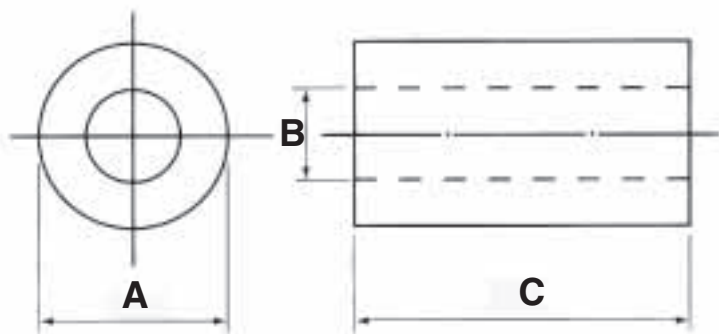

# FERRITES BEAD CORES (RRH)

## TYPICAL DATA

### RRH035-018-050

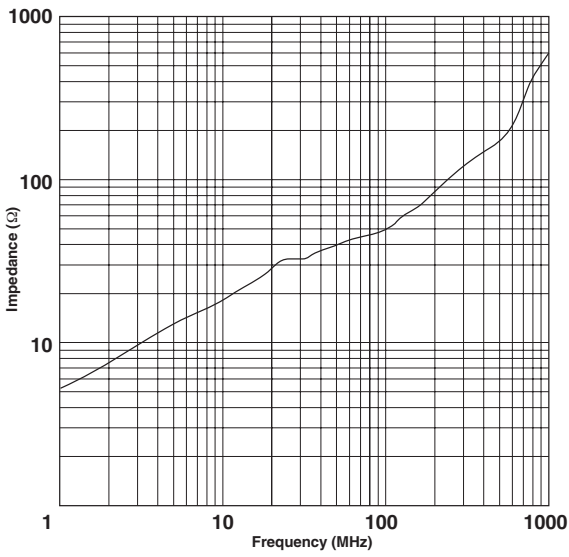

### RRH040-020-050

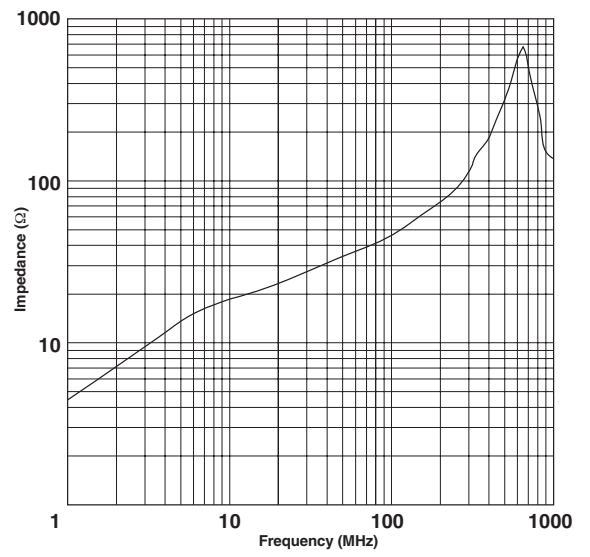

### RRH040-020-070

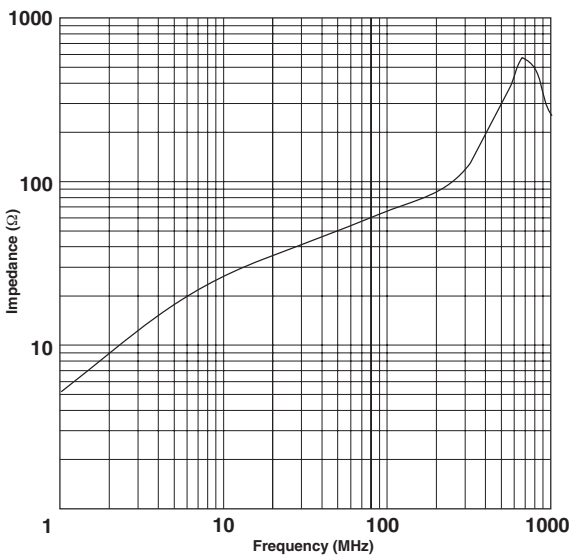

### RRH048-023-064

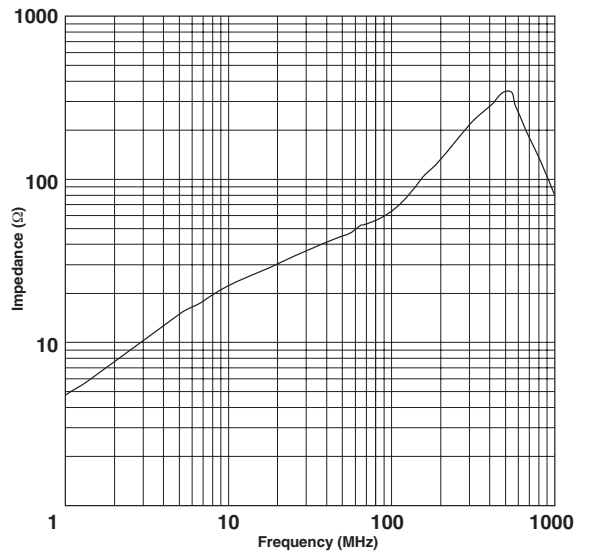

### RRH050-015-110

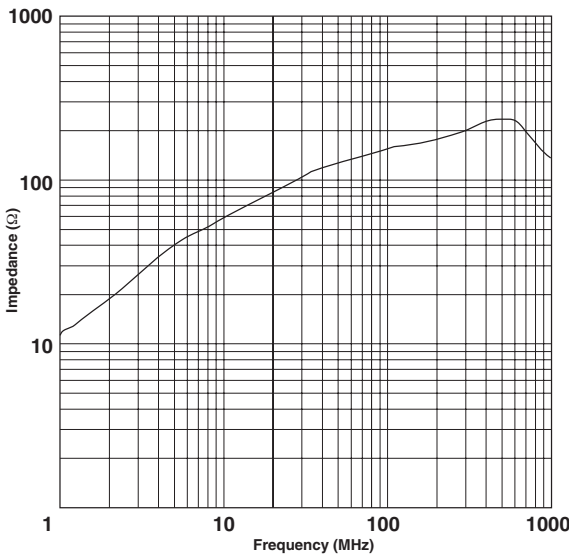

### RRH080-032-101

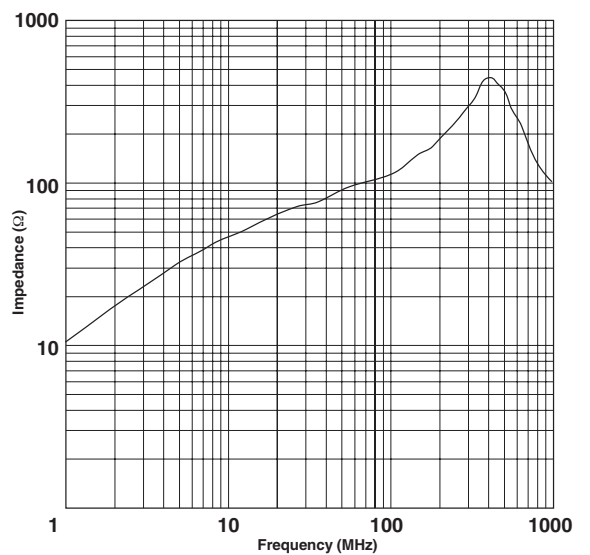

# FERRITES BEAD CORES (RRH)

## TYPICAL DATA

### RRH095-050-195

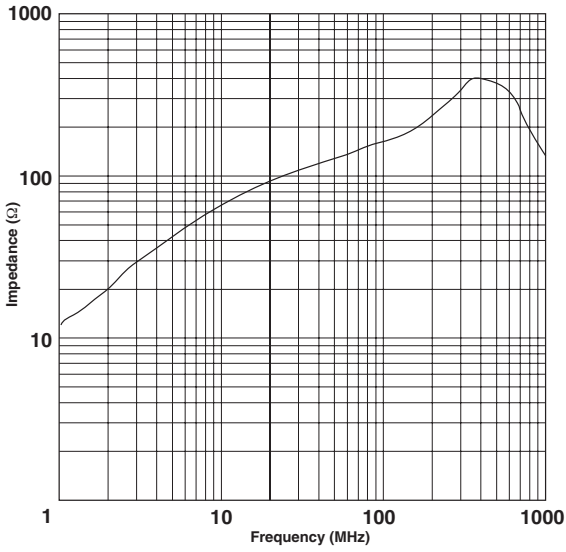

### RRH095-058-100

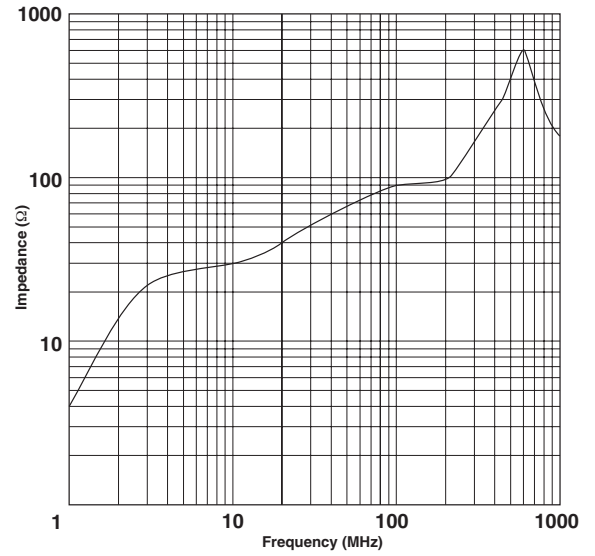

### RRH100-060-140

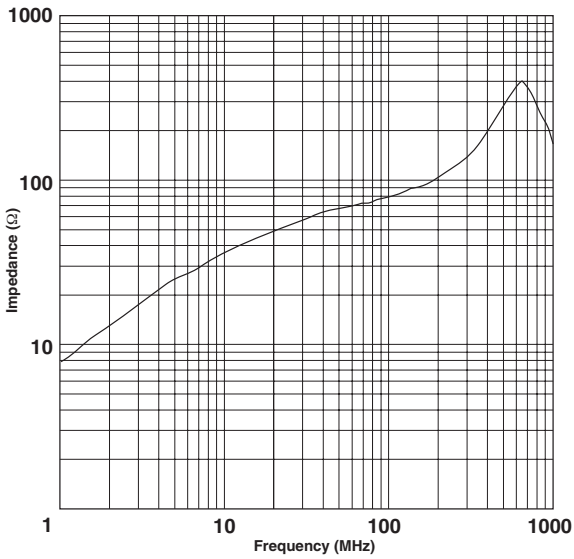

### RRH120-056-200

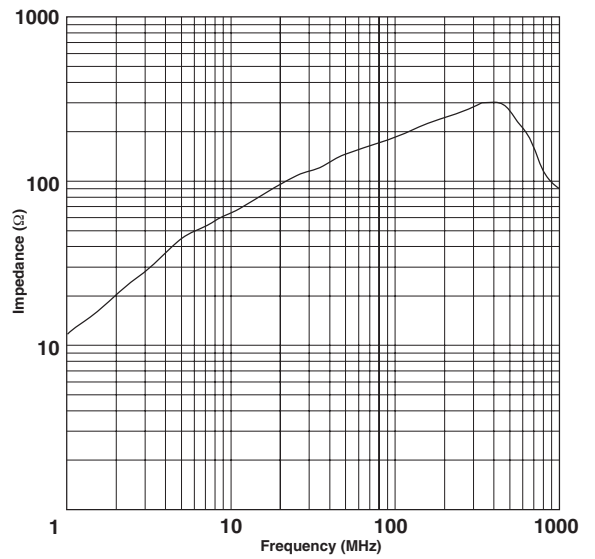

### RRH120-070-150

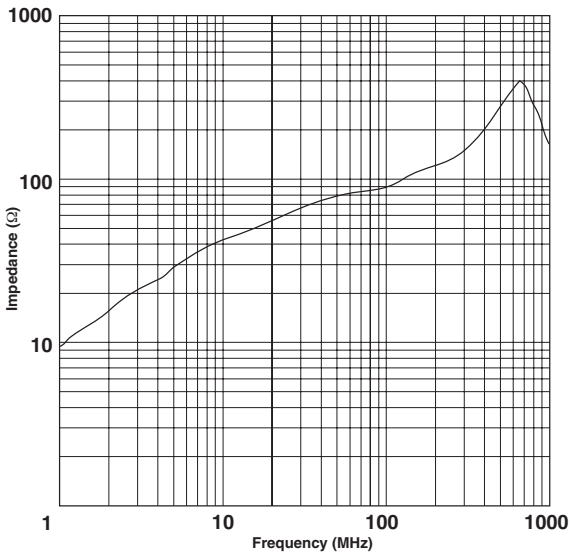

### RRH123-049-254

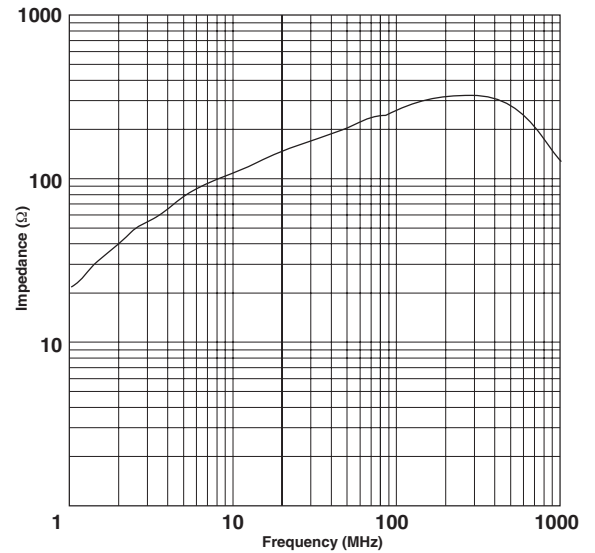

## TYPICAL DATA

**RRH142-080-285**

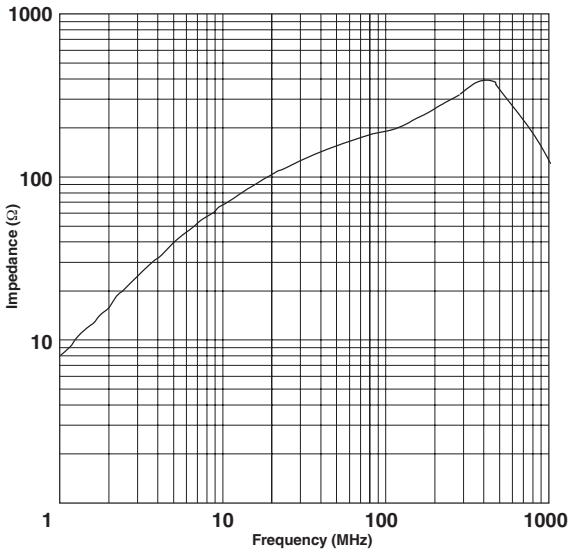

**RRH149-070-279**

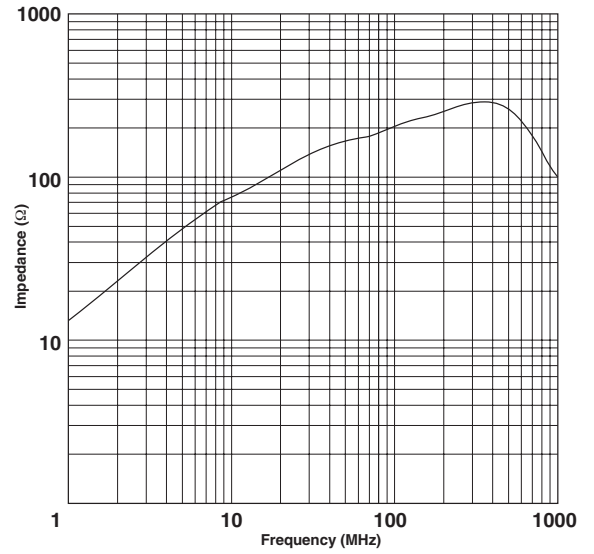

**RRH159-079-286**

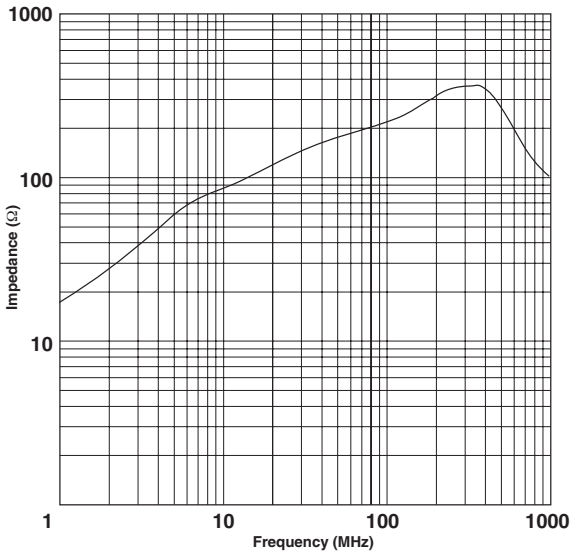

**RRH160-070-280**

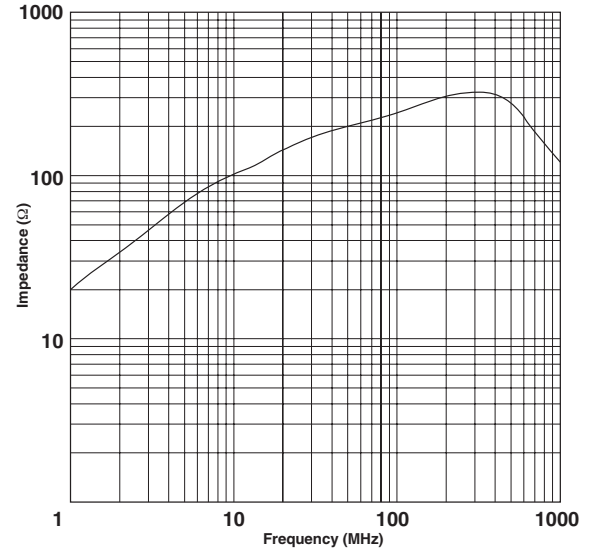

**RRH160-090-285**

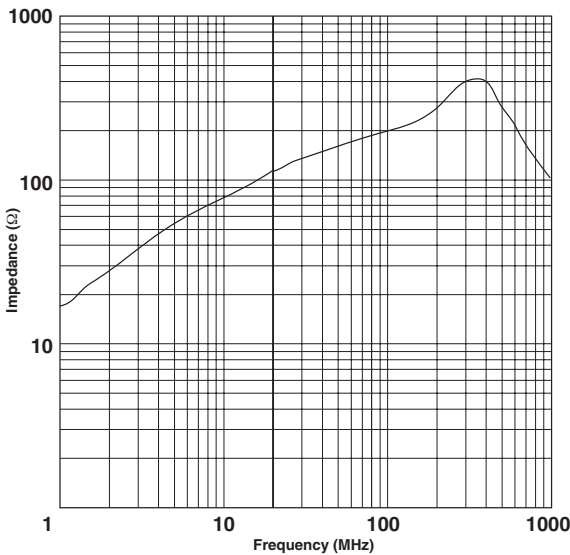

**RRH175-095-285**

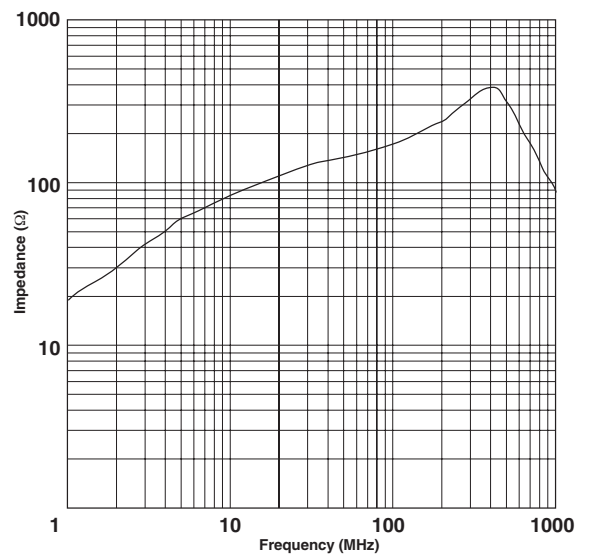

# FERRITES BEAD CORES (RRH)

## TYPICAL DATA

### RRH175-107-285

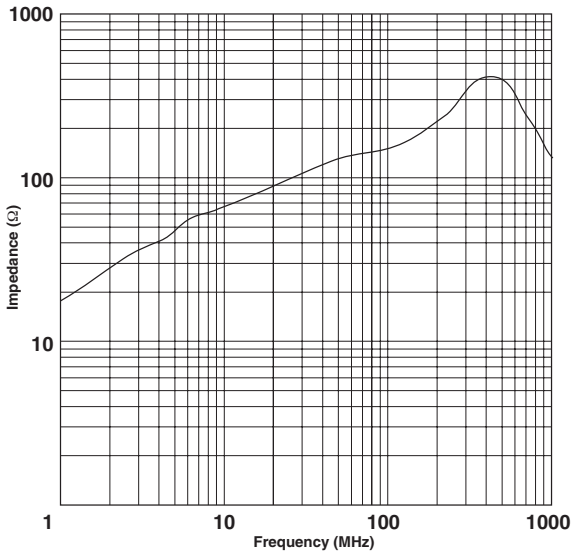

### RRH180-100-280

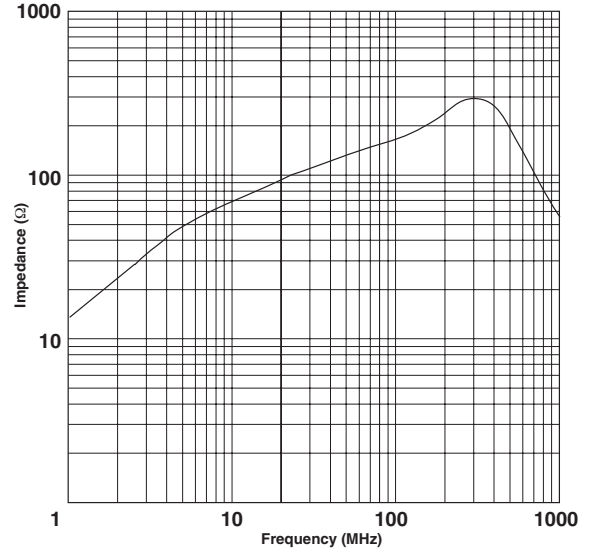

### RRH180-100-290

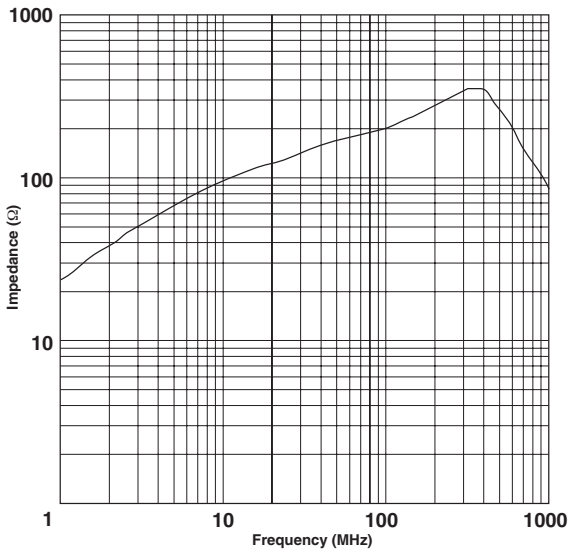

### RRH190-058-315

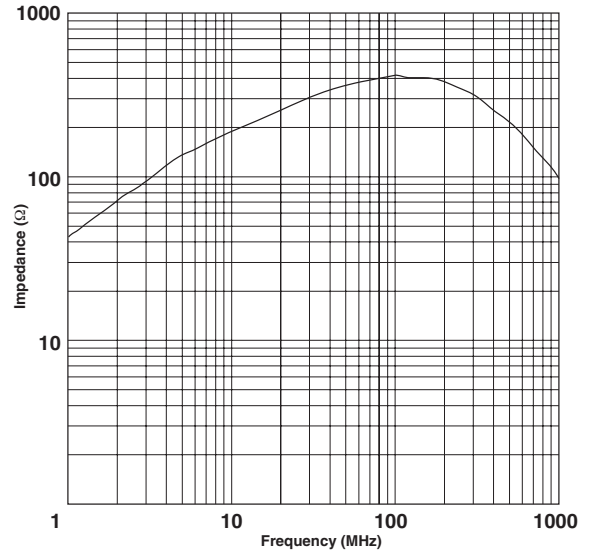

### RRH259-128-286

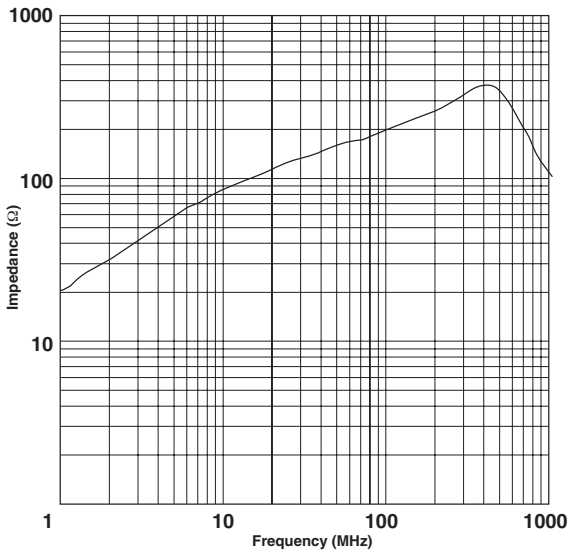

### RRH285-138-286

